

Drain: SPRINGS OF CAMBRIDGE DRAIN **Drain #:** 262
Improvement/Arm: SPRINGS OF CAMBRIDGE - SECTION 3
Operator: JOH **Date:** 7-1-04
Drain Classification: Urban/Rural **Year Installed:** 1994

GIS Drain Input Checklist

- Pull Source Documents for Scanning JOH
- Digitize & Attribute Tile Drains N/A
- Digitize & Attribute Storm Drains JOH
- Digitize & Attribute SSD JOH
- Digitize & Attribute Open Ditch JOH JOH
- Stamp Plans JOH
- Sum drain lengths & Validate JOH
- Enter Improvements into Posse JOH
- Enter Drain Age into Posse JOH
- Sum drain length for Watershed in Posse JOH
- Check Database entries for errors JOH

**Gasb 34 Footages for Historical Cost
Drain Length Log**

Drain-Improvement: SPRINGS OF CAMBRIDGE DRAIN-SPRINGS OF CAMBRIDGE-SECTION 3

Drain Type:	Size:	Length <i>Surveys Reports</i>	Length (DB Query)	Length Reconcile	If Applicable	
					Price:	Cost:
SSD	6"	7268.4'	7268.4	Ø		
RCP	12"	410'	410'	Ø		
	15"	445'	445'	Ø		
	18"	271'	271'	Ø		
	24"	542'	542'	Ø		
	30"	243'	243'	Ø		
	36"	103'	103'	Ø		
	42"	290'	290'	Ø		
OPEN DITCH		4483'	4483'	Ø		

Sum: 14055.4' 14,055.4' Ø

Final Report: _____

Comments:



SURVEYOR'S OFFICE

Hamilton County

Kenton C. Ward, Surveyor

Suite 146

776-8495

One Hamilton County Square

Noblesville, Indiana 46060-2230

April 18, 1996

To: Hamilton County Drainage Board

Re: Springs of Cambridge, Sections 3 & 4

Attached are petitions non-enforcement requests plans, calculations, quantity summary and assessment roll for Sections 3 & 4 of The Springs of Cambridge Drain. I have reviewed the submittals and petition and have found each to be in proper form.

I have made a personal inspection of the land described in both petitions. Upon doing so, I believe that the drain is practicable; will improve the public health; benefit a public highway and be of public utility; and that the costs, damages and expenses of the proposed drain will probably be less than the benefits accruing to the owners of land likely to be benefited. The drain will consist of the following:

<u>Section 3</u>	<u>Section 4</u>
6" SSD-7268.4 ft	6" SSD-8051.42 ft
Open Ditch-4483 ft	12" RCP-1128 ft
12" RCP-410 ft	15" RCP- 731 ft
15" RCP-445 ft	18" RCP- 652 ft
18" RCP-271 ft	24" RCP- 943 ft
24" RCP-542 ft	30" RCP- 202 ft
30" RCP-243 ft	
36" RCP-103 ft	
42" RCP-290 ft	

14,055.4

The total length of the drain will be 14,055.4 feet for Section 3 and 11,707.42 feet for Section 4.

The open ditch shown above included Bee Camp Creek from Geist Reservoir to Olio Road; the section of open drain from the outlet on Lot 113, STR 760, across Block E and the rear of Lot 105 to STR 754 located in the East R/W for Spring Stone Road; The open ditch in the rear of Lots 78 to 83 and 92 to 95 from STR 767 to the corner of lots 78 and 95; the open ditch in the rear of lots 77,78,95,96 and 97; and in the rear of lots 97 to 102 across Block F from STR 788 to Bee Camp Creek.

Marina Limited Partnership has been placed between Lots 165-166 to Lots 96-97. This is temporary in that the swale will be relocated when the tract on which it is located is developed as a future section. The length of this swale is not included in the total length of drain for Sections 3 and 4.

The subsurface drains (SSD) to be part of the regulated drain are those located under the curbs and those main lines between lots or in rear yards. Only the main SSD lines which are located within the easement/right of way are to be maintained as regulated drain. Laterals for individual lots will not be considered part of the regulated drain. The portion of the SSD which will be regulated other than those under curbs are as follows:

Section 3 - Temporary swale in rear of lots 77,78,95, 96 and 97

Section 4 - Between Lots 174 and 175 and between Lots 150, 156, 151, 155 and 155, 152

I have reviewed the plans and believe the drain will benefit each lot equally. Therefore, I recommend each lot be assessed equally. I also believe that no damages will result to landowners by the construction of this drain. I recommend a maintenance assessment of \$30.00 per lot, \$5.00 per acre for roadways, with a \$30.00 minimum. With this assessment the total annual assessment for this drain/this section will be \$ 3638.75.

Parcels assessed for this drain may be assessed for The Bee Camp Creek Drain at sometime in the future.

I believe this proposed drain meets the requirements for Urban Drain Classification as set out in IC 36-9-27-67 to 69. Therefore, this drain shall be designated as an Urban Drain.

I recommend that upon approval of the above proposed drain that the Board also approve the attached non-enforcement request. This request is for the reduction of the regulated drain easement to those easement widths as shown on the secondary plat for Springs of Cambridge, Section 3 and 4 as recorded in the office of the Hamilton County Recorder.

I recommend the Board set a hearing for this proposed drain for June 1996.

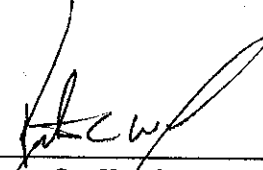

Kenton C. Ward
Hamilton County Surveyor

KCW/ndw



NBD Bank, N.A.
International Operations
One Indiana Square
Indianapolis, Indiana 46266
(317) 266-5395

In All Correspondence
Quote Our Reference No.

TELEX: MCI205615

◀ By Mail By Wire ▶

S.W.I.F.T.: INBI US44

FAX: (317) 266-7150

IRREVOCABLE LETTER OF CREDIT NO. S036608

JULY 13, 1994

BENEFICIARY
HAMILTON COUNTY COMMISSIONERS &
HAMILTON COUNTY DRAINAGE BOARD
COURT HOUSE
NOBLESVILLE, IN 46060

APPLICANT
THE MARINA I L.P.,
11691 FALL CREEK ROAD
INDPLS., IN 46256

EXPIRATION DATE: JULY 15, 1995 AMOUNT: 225,520.00

WE HEREBY ISSUE IN YOUR FAVOR THIS IRREVOCABLE LETTER OF CREDIT WHICH IS AVAILABLE AGAINST THE FOLLOWING DOCUMENTS:
THE ORIGINAL OF THIS LETTER OF CREDIT AND DRAFTS DRAWN AT SIGHT ON NBD BANK, N.A., INDIANAPOLIS, IN BEARING THE CLAUSE "DRAWN UNDER IRREVOCABLE LETTER OF CREDIT NO. S036608 DATED JULY 13, 1994."

CERTIFICATION BY THE HAMILTON COUNTY COMMISSIONERS AND HAMILTON COUNTY HIGHWAY DEPARTMENT OF NOBLESVILLE, INDIANA, FOR NON-COMPLIANCE WITH THE SPECIFICATIONS REQUIRED FOR STORM SEWERS IN THE SPRINGS OF CAMBRIDGE SUBDIVISION SECTION(S) 3 & 4 BY THE MARINA I L.P., SUCH CERTIFICATION NOT TO ANTEDATE THE LETTER OF CREDIT; AND

CERTIFICATION BY THE HAMILTON COUNTY COMMISSIONERS AND HAMILTON COUNTY HIGHWAY DEPARTMENT OF NOBLESVILLE, INDIANA, THAT FUNDS DRAWN UNDER THIS LETTER OF CREDIT WILL BE USED TO BRING THE STORM SEWERS INTO COMPLIANCE IN ACCORDANCE WITH THE SPECIFICATIONS REFERENCED.

WE HEREBY ENGAGE WITH YOU DRAWERS AND/OR BONA FIDE HOLDERS THAT DRAFTS DRAWN AND NEGOTIATED IN CONFORMITY WITH THE TERMS OF THIS CREDIT WILL BE DULY HONORED ON PRESENTATION AND THAT DRAFTS ACCEPTED WITHIN THE TERMS OF THIS CREDIT WILL BE DULY HONORED AT MATURITY.

EXCEPT SO FAR AS OTHERWISE EXPRESSLY STATED, THIS CREDIT IS SUBJECT TO THE UNIFORM CUSTOMS AND PRACTICE FOR DOCUMENTARY CREDITS, 1993 REVISION, INTERNATIONAL CHAMBER OF COMMERCE PUBLICATION NO. 500.

REGARDS,

AUTHORIZED SIGNATURE



NBD Bank, N.A.
 International Operations, MS 1624
 One Indiana Square
 Indianapolis, Indiana 46266
 (313) 266-5395

In All Correspondence
 Quote Our Reference No.

TELEX: MCI205615

◀ By Mail By Wire ▶

S.W.I.F.T.: INBI US44

FAX: (317) 266-7150

IRREVOCABLE STANDBY LETTER OF CREDIT NO. 5036649
 AUGUST 03, 1994

 *** B E N E F I C I A R Y *** | *** A P P L I C A N T ***
 HAMILTON COUNTY COMMISSIONERS | THE MARINA 1 L.P.
 AND HAMILTON COUNTY | 11691 FALL CREEK ROAD
 DRAINAGE BOARD | INDIANAPOLIS, IN 46256
 NOBLESVILLE, IN 46160 |

*** EXPIRY DATE/PLACE *** | *** AVAILABLE AT/BY: ***
 EXPIRES ON AUGUST 15, 1995 | OUR OFFICE ONLY BY PRESENTATION
 FOR PRESENTATION AT OUR OFFICE. | OF DOCUMENT(S) REQUIRED AND YOUR
 | DRAFT(S) DRAWN AT SIGHT.

 A M O U N T O F C R E D I T : NOT TO EXCEED, IN THE AGGREGATE
 15,000.00 U.S. DOLLARS

AT THE REQUEST AND FOR THE ACCOUNT OF THE ABOVE NAMED APPLICANT,
 WE HEREBY ESTABLISH OUR IRREVOCABLE LETTER OF CREDIT IN YOUR
 FAVOR WHICH IS AVAILABLE AS INDICATED ABOVE AGAINST PRESENTATION
 OF YOUR DRAFT(S) DRAWN ON NBD BANK, N.A., INDIANAPOLIS, INDIANA,
 WHEN ACCOMPANIED BY ORIGINAL OF THIS LETTER OF CREDIT AND THE
 FOLLOWING DOCUMENTS:

CERTIFICATION BY THE HAMILTON COUNTY COMMISSIONERS AND HAMILTON
 COUNTY DRAINAGE BOARD OF NOBLESVILLE, INDIANA, FOR NON-
 COMPLIANCE WITH THE SPECIFICATIONS REQUIRED FOR EROSION CONTROL
 IN THE SPRINGS OF CAMBRIDGE, SECTIONS 3 & 4 BY THE MARINA 1, LP,
 SUCH CERTIFICATION NOT TO ANTEDATE THE LETTER OF CREDIT; AND

CERTIFICATION BY THE HAMILTON COUNTY COMMISSIONERS AND HAMILTON
 COUNTY DRAINAGE BOARD OF NOBLESVILLE, INDIANA, THAT FUNDS DRAWN
 UNDER THIS LETTER OF CREDIT WILL BE USED TO BRING THE EROSION
 CONTROL INTO COMPLIANCE IN ACCORDANCE WITH THE SPECIFICATIONS
 REFERENCED.

WE HEREBY ENGAGE WITH DRAWERS AND/OR BONA FIDE HOLDERS THAT
 DRAFTS DRAWN AND NEGOTIATED IN CONFORMITY WITH THE TERMS OF THIS
 CREDIT WILL BE DULY HONORED AT PRESENTATION AND THAT DRAFTS
 ACCEPTED WITHIN THE TERMS OF THIS CREDIT WILL BE DULY HONORED AT
 MATURITY.

EXCEPT SO FAR AS OTHERWISE EXPRESSLY STATED, THIS CREDIT IS
 SUBJECT TO THE UNIFORM CUSTOMS AND PRACTICE FOR DOCUMENTARY
 CREDITS, 1993 REVISION, INTERNATIONAL CHAMBER OF COMMERCE
 PUBLICATION NO. 500.

REGARDS,

Frederick A. Walker



NBD Bank, N.A.
 International Operations, MS 1624
 One Indiana Square
 Indianapolis, Indiana 46266
 (317) 266-5395
 317

In All Correspondence
 Quote Our Reference No.

TELEX: MCI205615

◀ By Mail By Wire ▶

S.W.I.F.T.: INBI US44

FAX: (317) 266-7150

IRREVOCABLE STANDBY LETTER OF CREDIT NO. 5036974
 APRIL 04, 1995

 *** B E N E F I C I A R Y *** | *** A P P L I C A N T ***
 HAMILTON COUNTY COMMISSIONERS | THE MARINA 1 L.P.
 & HAMILTON COUNTY DRAINAGE BOARD | 11691 FALL CREEK ROAD
 | INDIANAPOLIS, IN 46256
 |

*** EXPIRY DATE/PLACE *** | *** AVAILABLE AT/BY: ***
 EXPIRES ON APRIL 06, 1996 | OUR OFFICE ONLY BY PRESENTATION
 FOR PRESENTATION AT OUR OFFICE. | OF DOCUMENT(S) REQUIRED AND YOUR
 | DRAFT(S) DRAWN AT SIGHT.

 A M O U N T O F C R E D I T : NOT TO EXCEED, IN THE AGGREGATE
 59,300.00 U.S. DOLLARS

AT THE REQUEST AND FOR THE ACCOUNT OF THE ABOVE NAMED APPLICANT,
 WE HEREBY ESTABLISH OUR IRREVOCABLE LETTER OF CREDIT IN YOUR
 FAVOR WHICH IS AVAILABLE AS INDICATED ABOVE AGAINST PRESENTATION
 OF YOUR DRAFT(S) DRAWN ON NBD BANK, N.A., INDIANAPOLIS, INDIANA,
 WHEN ACCOMPANIED BY ORIGINAL OF THIS LETTER OF CREDIT
 AND THE FOLLOWING DOCUMENT(S):

CERTIFICATION BY THE HAMILTON COUNTY COMMISSIONERS AND HAMILTON
 COUNTY DRAINAGE BOARD OF NOBLESVILLE, IN, FOR NON-COMPLIANCE
 WITH THE SPECIFICATIONS REQUIRED FOR SUBSURFACE IN THE SPRINGS
 OF CAMBRIDGE, SECTIONS 3 & 4 BY THE MARINA 1, L.P., SUCH
 CERTIFICATION NOT TO ANTEDATE THE LETTER OF CREDIT; AND

CERTIFICATIN BY THE HAMILTON COUNTY COMMISSIONERS AND HAMILTON
 COUNTY DRAINAGE BOARD OF NOBLESVILLE, IN, THAT FUNDS DRAWN
 UNDER THIS LETTER OF CREDIT WILL BE USED TO BRING THE EROSION
 CONTROL INTO COMPLIANCE IN ACCORDANCE WITH THE SPECIFICATIONS
 REFERENCED.

WE HEREBY ENGAGE WITH DRAWERS AND/OR BONA FIDE HOLDERS THAT
 DRAFTS DRAWN AND NEGOTIATED IN CONFORMITY WITH THE TERMS OF THIS
 CREDIT WILL BE DULY HONORED AT PRESENTATION.

EXCEPT SO FAR AS OTHERWISE EXPRESSLY STATED, THIS CREDIT IS
 SUBJECT TO THE UNIFORM CUSTOMS AND PRACTICE FOR DOCUMENTARY
 CREDITS, 1993 REVISION, INTERNATIONAL CHAMBER OF COMMERCE
 PUBLICATION NO. 500.

REGARDS,

Stephen A. Hatcher
 AUTHORIZED SIGNATURE

Glenda C. Skienaw
 AUTHORIZED SIGNATURE

CERTIFICATE OF COMPLETION AND COMPLIANCE

TO: HAMILTON COUNTY SURVEYOR

RE: The Springs of Cambridge Subdivision, Section Three
Regulated Drain

I hereby certify that:

- 1.) I am a Registered Land Surveyor In the State of Indiana,
- 2.) I am familiar with the plans and specifications for the above referenced subdivision,
- 3.) I have personally observed and supervised the completion of the Drainage Facilities for the above referenced subdivision, and
- 4.) To the best of my knowledge, information and belief, the Drainage Facilities within the subdivision has been installed and completed in conformity with all plans and specifications.

Signature: Joseph A. Sharp Date: October 9, 1995

Type or Printed Name: Joseph A. Sharp

Business Address: 7172 Graham Road
Indianapolis, IN 46250

Telephone: (317) 842-6777

INDIANA REGISTERED NUMBER

S0076

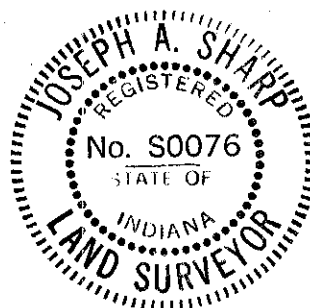

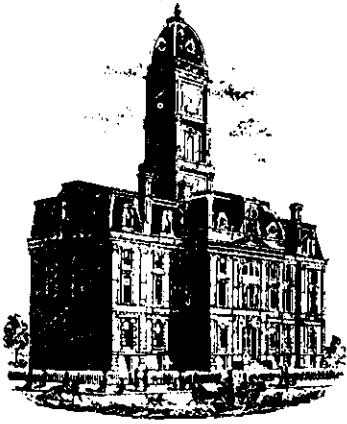

SURVEYOR'S OFFICE
Hamilton County

Kenton C. Ward, Surveyor

Phone (317) 776-8495

Fax (317) 776-9628

Suite 146

One Hamilton County Square

Noblesville, Indiana 46060-2230

To: Hamilton County Drainage Board

July 7, 1997

Re: Springs of Cambridge - Sec. 3 arm

Attached are as-builts, certificate of completion & compliance, and other information for Springs of Cambridge Sec. 3. An inspection of the drainage facilities for this section has been made and the facilities were found to be complete and acceptable.

During construction of the drain there were not any significant changes made to the drain. Subsequently, there were not any significant changes made to the plans submitted with my report dated April 18, 1996. Therefore, the length of the drain remains at **14,055.4 feet**.

The non-enforcement was approved by the Board at its meeting on June 10, 1996 and recorded under instrument #9609634467.

The bond or letter of credit from NBD Bank, number S036608 for storm sewers; S036649 for erosion control; and S306607 for monumentation, dated July 15, 1995 and August 15, 1995, in the amount of \$225,520.00; \$15,000.00; and \$3,000.00, has expired.

I recommend the Board approve the drains construction as complete and acceptable.

Sincerely,

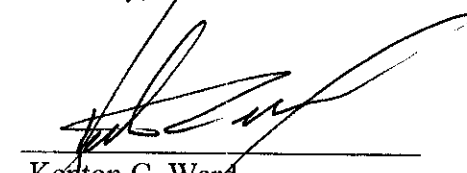

Kenton C. Ward,
Hamilton County Surveyor

KCW/slm



Q = CIA
 100 = 0.55 X 4.5 X 5.8
 = 14.4 CFS
 ADD 10 CFS (EXISTING 24" DISCHARGES AT LOT 143 UPSTREAM)
 = 24.4 CFS CAPACITY REQUIRED
 CAPACITY PROVIDED: (24" @ 1% = 25 CFS)

WATERSHED = 5.8 ACRES

FILED
 MAY 27 2004
 OFFICE OF HAMILTON COUNTY SUPERVISOR

HOLEY MOLEY'S SAYS CALL AT LEAST TWO FULL WORKING DAYS BEFORE YOU DIG THE HOLE.
 CAUTION
 LOCATIONS OF ALL EXISTING UNDERGROUND UTILITIES SHOWN ON THIS PLAN ARE BASED UPON ABOVE GROUND EVIDENCE (INCLUDING, BUT NOT LIMITED TO, MANHOLES, JELLS, VALVES, AND MARKS MADE UPON THE GROUND BY OTHERS) AND ARE SPECULATIVE IN NATURE. THERE MAY ALSO BE OTHER EXISTING UNDERGROUND UTILITIES FOR WHICH THERE IS NO ABOVE GROUND EVIDENCE OR FOR WHICH NO ABOVE GROUND EVIDENCE WAS OBSERVED. THE EXACT LOCATIONS OF SAID EXISTING UNDERGROUND UTILITIES SHOULD BE VERIFIED BY THE CONTRACTOR PRIOR TO ANY AND ALL CONSTRUCTION.



1-800-382-6544
 CALL TOLL FREE
 1-800-428-5200
 FOR CALLS OUTSIDE OF INDIANA

Revision	Mark	Date	Description

ARCHITECTURE ARCHITECTURE
 CIVIL ENGINEERS CIVIL ENGINEERS
 LAND PLANNING LAND PLANNING
 LAND SURVEYORS LAND SURVEYORS
 TRANSPORTATION ENGINEERS TRANSPORTATION ENGINEERS
 GIS GIS

7172 GRAHAM ROAD
 INDIANAPOLIS, INDIANA 46250
 (317) 842-6777 FAX (317) 841-4798
 E-Mail crpe@crpe.biz

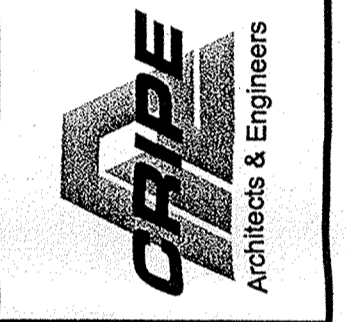

WATERSHED AREA
 Remedial Storm Sewer and Erosion Control
 The Springs of Cambridge, Section 3
 HAMILTON COUNTY, INDIANA
 LOT 97

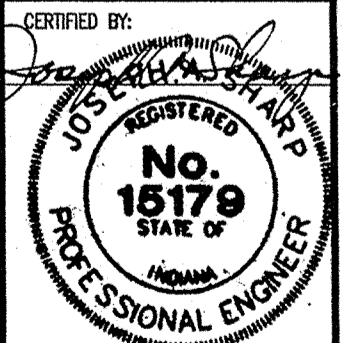

4-27-04
 Drawn By:
 Checked By:
 Quality Assurance:
 Scale: 0" = 50'
 Sheet: C701
 Date: 04-27-04
 Project Number: 960510-20000

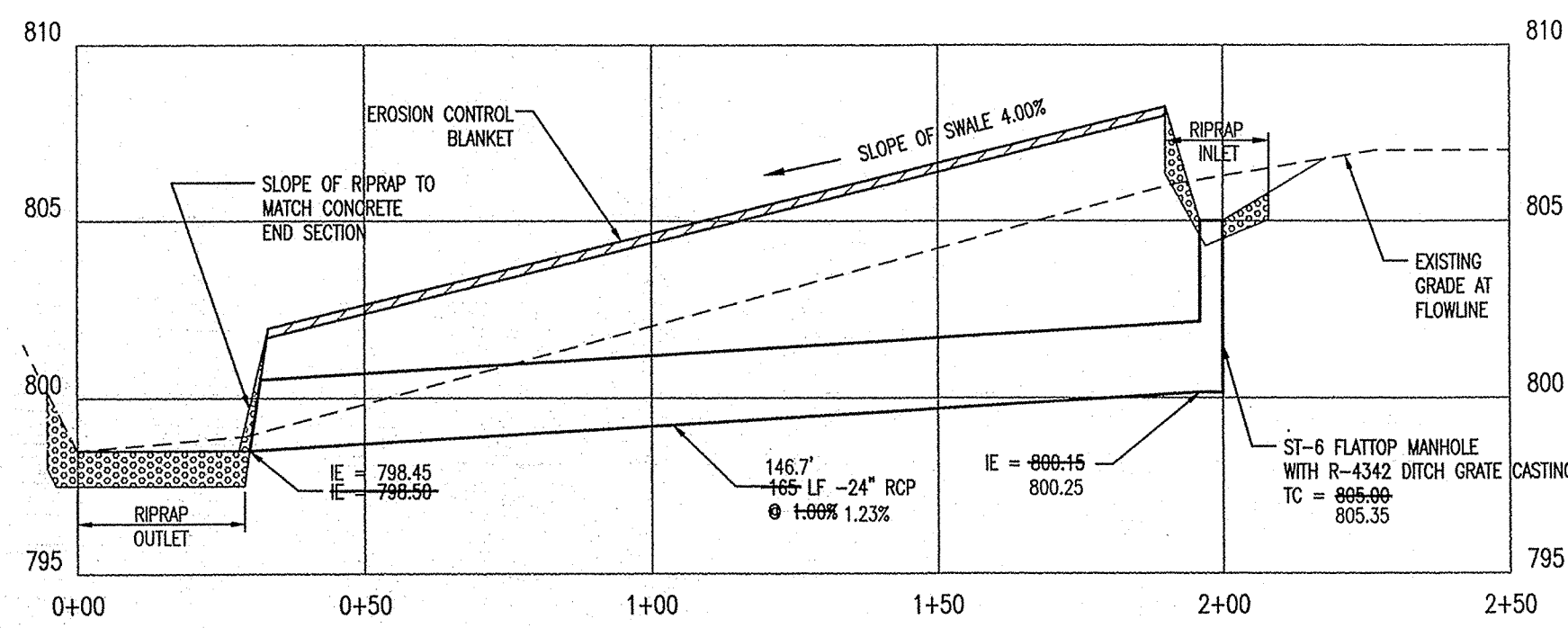

PROFILE VIEW

HORIZONTAL SCALE: 1" = 30'
VERTICAL SCALE: 1" = 5'

This information was gathered for input into the Hamilton County Geographical Information System. This document is considered an official record of the GIS.

Entry Date: 1-11-05
Entered by: Suzanne Mills

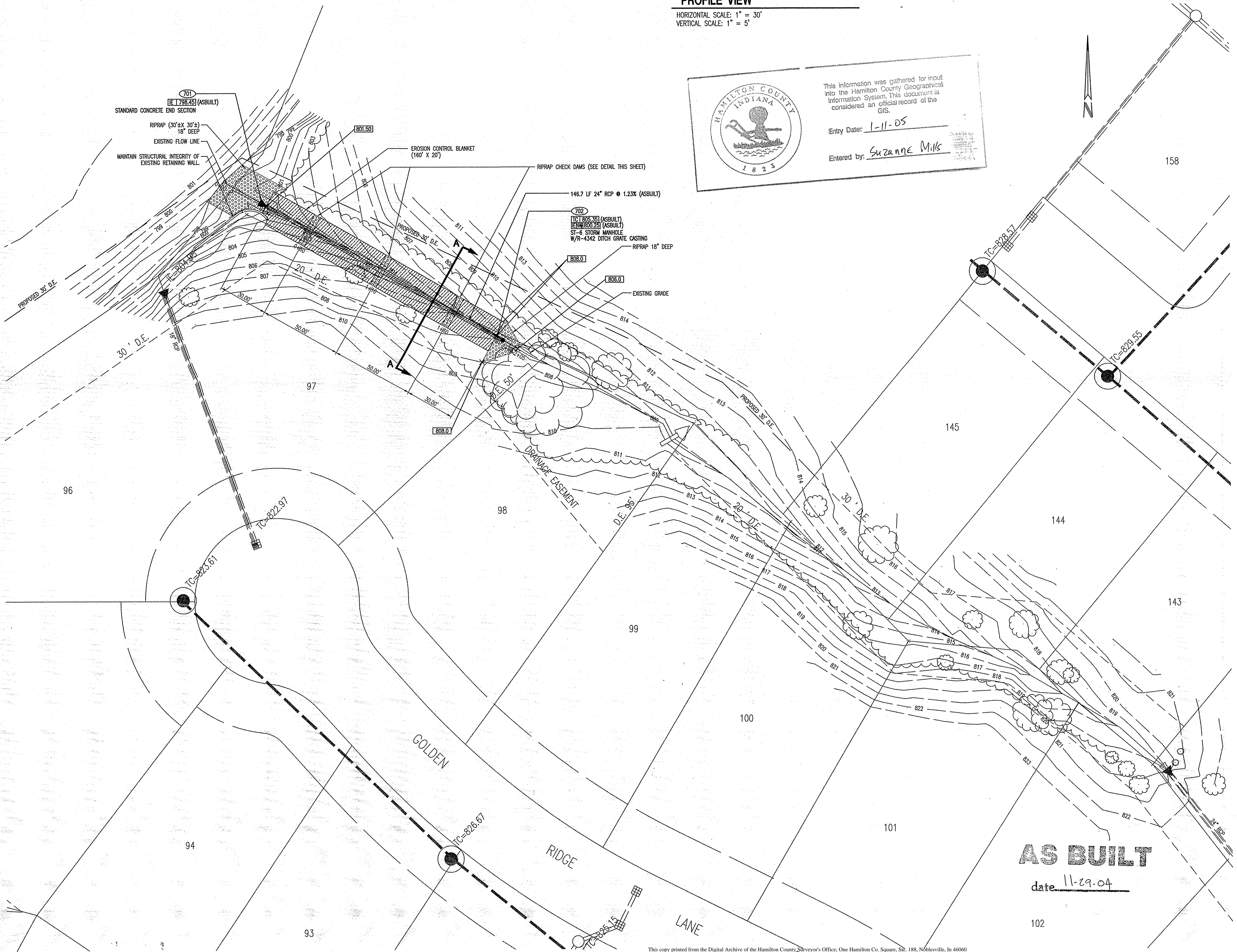

LEGEND

ROCK CHECK DAM SEE DETAIL THIS SHEET

EROSION CONTROL BLANKET

NOTES

1. SEED ALL DISTURBED AREAS BEYOND EROSION CONTROL BLANKET WITH KENTUCKY # 31 FESCUE AND ANNUAL RYE GRASS.

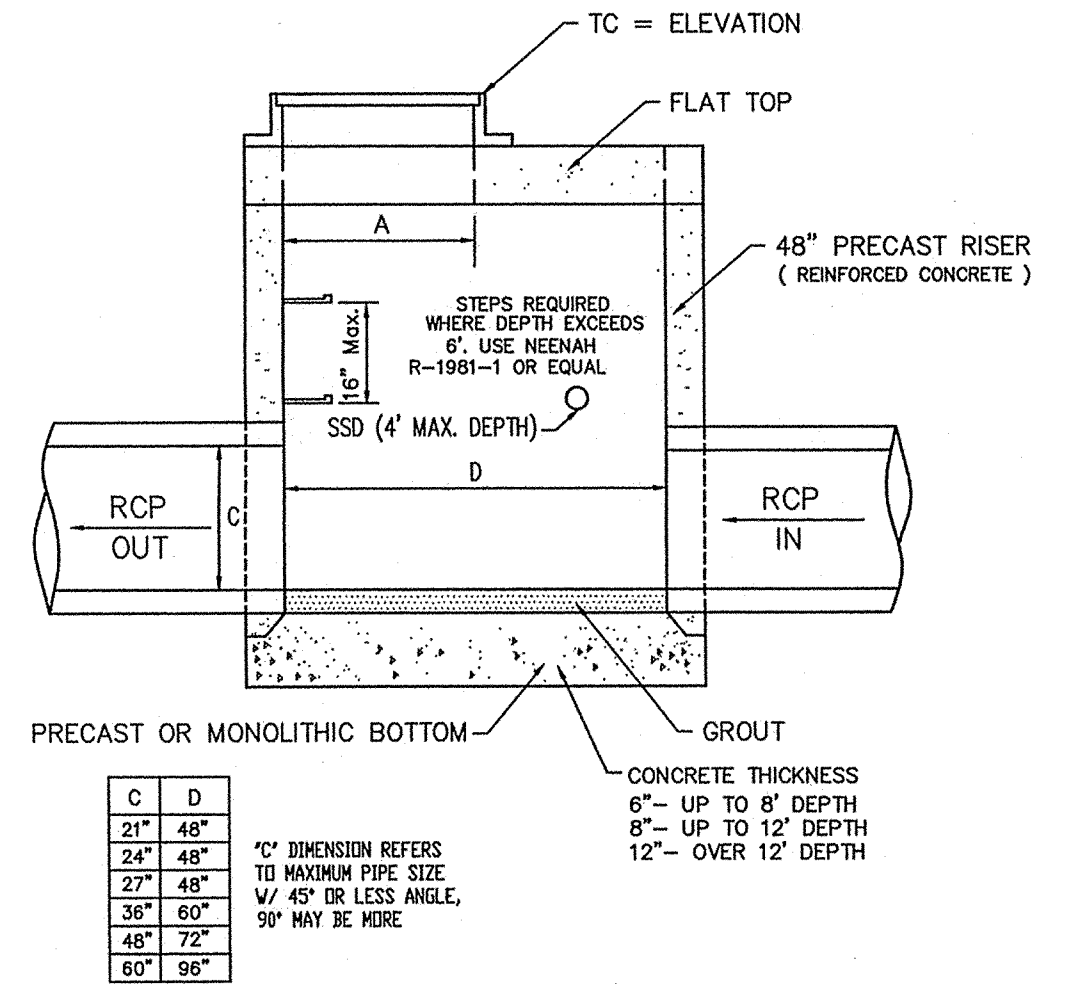

STORM SEWER MANHOLE WITH FLAT TOP REDUCER

NO SCALE

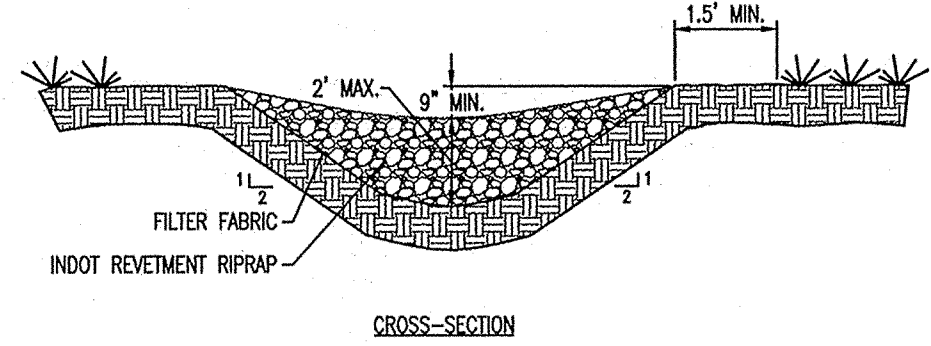
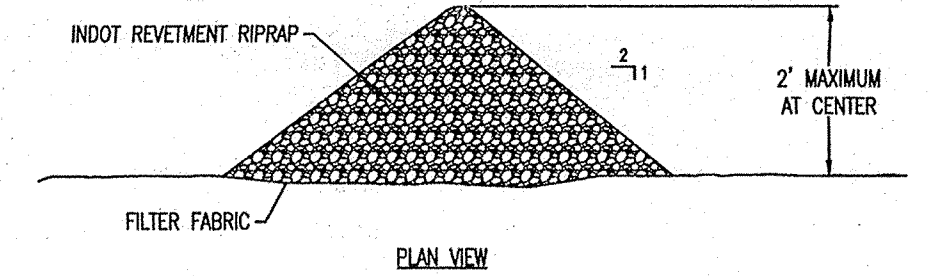
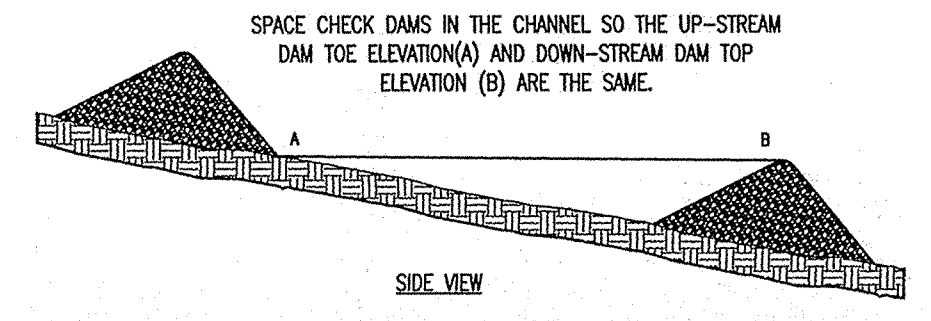

- INSPECT CHECK DAMS AND THE CHANNEL AFTER EACH STORM EVENT, AND REPAIR ANY DAMAGE IMMEDIATELY.
- IF SIGNIFICANT EROSION OCCURS BETWEEN DAMS, INSTALL A RIPRAP LINER IN THAT PORTION OF THE CHANNEL (PRACTICE 3.32).
- REMOVE SEDIMENT ACCUMULATED BEHIND EACH DAM AS NEEDED TO MAINTAIN CHANNEL CAPACITY, TO ALLOW DRAINAGE THROUGH THE DAM, AND PREVENT LARGE FLOWS FROM DISPLACING SEDIMENT.
- ADD ROCK TO THE DAMS AS NEEDED TO MAINTAIN DESIGN HEIGHT AND CROSS SECTION.
- WHEN THE DAMS ARE NO LONGER NEEDED, REMOVE THE ROCK AND STABILIZE CHANNEL, USING AN EROSION RESISTANT LINING IF NECESSARY.

ROCK CHECK DAM

NO SCALE

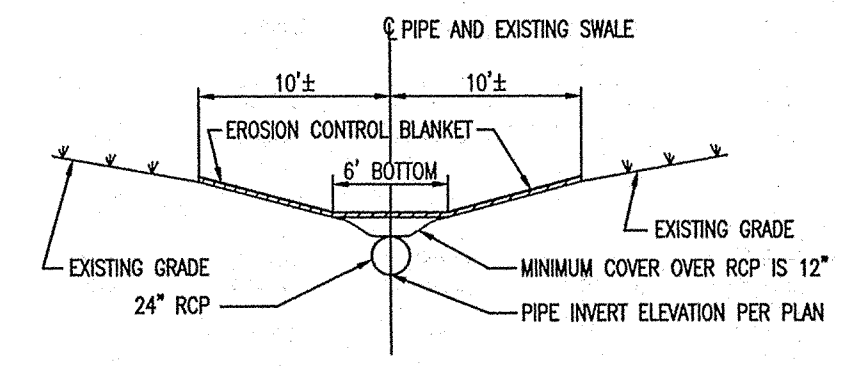

TYPICAL CROSS SECTION "A-A"

SCALE: 1" = 10'

CAUTION
LOCATIONS OF ALL EXISTING UNDERGROUND UTILITIES SHOWN ON THIS PLAN ARE BASED UPON ABOVE GROUND EVIDENCE (including, but not limited to, manholes, inlets, valves, and marks made upon the ground by others) AND ARE SPECULATIVE IN NATURE. THERE MAY ALSO BE OTHER EXISTING UNDERGROUND UTILITIES FOR WHICH THERE IS NO ABOVE GROUND EVIDENCE OR FOR WHICH NO ABOVE GROUND EVIDENCE WAS OBSERVED. THE EXACT LOCATIONS OF SAID EXISTING UNDERGROUND UTILITIES SHOULD BE VERIFIED BY THE CONTRACTOR PRIOR TO ANY AND ALL CONSTRUCTION.

1-800-382-5544
CALL TOLL FREE
1-800-428-5200
FOR CALLS OUTSIDE OF INDIANA

AS BUILT

date 11-29-04

ARCHITECTURE
CIVIL ENGINEERS
LAND PLANNING
LAND SURVEYING
REGISTERED PROFESSIONAL ENGINEERS

7172 GRAHAM ROAD
INDIANAPOLIS, INDIANA 46250
(317) 842-6777 FAX (317) 841-7798
E-Mail: crpe@crpe.biz

CRPE
Architects & Engineers

STORM PLAN AND DETAILS
Remedial Storm Sewer and Erosion Control
The Springs of Cambridge, Section 3
HAMILTON COUNTY, INDIANA
LOT 97

CERTIFIED BY:
Joseph A. Sharr
JOSEPH A. SHARR
REGISTERED
No. 15179
STATE OF INDIANA
PROFESSIONAL ENGINEER

Drawn By:
HUTCH

Checked By:

Quality Assurance:

Scale: 1" = 30'

Sheet: **C702**

Date: 11-29-04

Project Number: 960510-30000

DON'T DIG BLIND

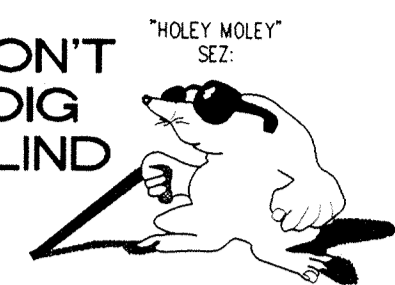

1-800-382-5544
CALL TOLL FREE
1-800-428-5200
FOR CALLS OUTSIDE OF INDIANA

CAUTION
LOCATIONS OF ALL EXISTING UNDERGROUND UTILITIES SHOWN ON THIS PLAN ARE BASED UPON ABOVE GROUND EVIDENCE (including, but not limited to, manholes, inlets, valves, and marks made upon the ground by others) AND ARE SPECULATIVE IN NATURE. THERE MAY ALSO BE OTHER EXISTING UNDERGROUND UTILITIES FOR WHICH THERE IS NO ABOVE GROUND EVIDENCE OR FOR WHICH NO ABOVE GROUND EVIDENCE WAS OBSERVED. THE EXACT LOCATIONS OF SAID EXISTING UNDERGROUND UTILITIES SHOULD BE VERIFIED BY THE CONTRACTOR PRIOR TO ANY AND ALL CONSTRUCTION.

- NOTES:**
- CUTS SHOWN ARE APPROXIMATE, TAKEN FROM EXISTING GRADE TO INVERT OF PIPE.
 - FIELD ADJUSTMENT BY ENGINEER MAY BE REQUIRED AT ALL OUTFALL POINTS TO INSURE PROPER OUTFALL CONDITIONS.
 - ALL STORM DRAINAGE STRUCTURES (IE: MANHOLES, CURB INLETS) SHALL HAVE POURED FLOW LINES AND BENCH WALLS. THE FLOW LINES AND BENCH WALLS SHALL BE TROWELED SMOOTH AND HAVE A BRUSHED FINISHED.
 - ALL STRUCTURES SHALL HAVE CASTINGS, JOINTS, LIFT RINGS AND PIPE CONNECTIONS WELL GROUDED, TROWELED SMOOTH AND BRUSH FINISHED.
 - OCCUPATIONAL SAFETY AND HEALTH ADMINISTRATION (OSHA) STANDARDS FOR EXCAVATIONS; FINAL RULE 29 CFR PART 1926, SUBPART "P" APPLIES TO ALL EXCAVATIONS EXCEEDING FIVE (5) FEET IN DEPTH.
 - IN ADDITION, EXCAVATIONS EXCEEDING TWENTY (20) FEET IN DEPTH REQUIRE THE DESIGN OF A TRENCH SAFETY SYSTEM BY A REGISTERED PROFESSIONAL ENGINEER. IT SHALL BE THE RESPONSIBILITY OF THE CONTRACTOR TO COMPLY WITH THE ABOVE STATED REQUIREMENTS.

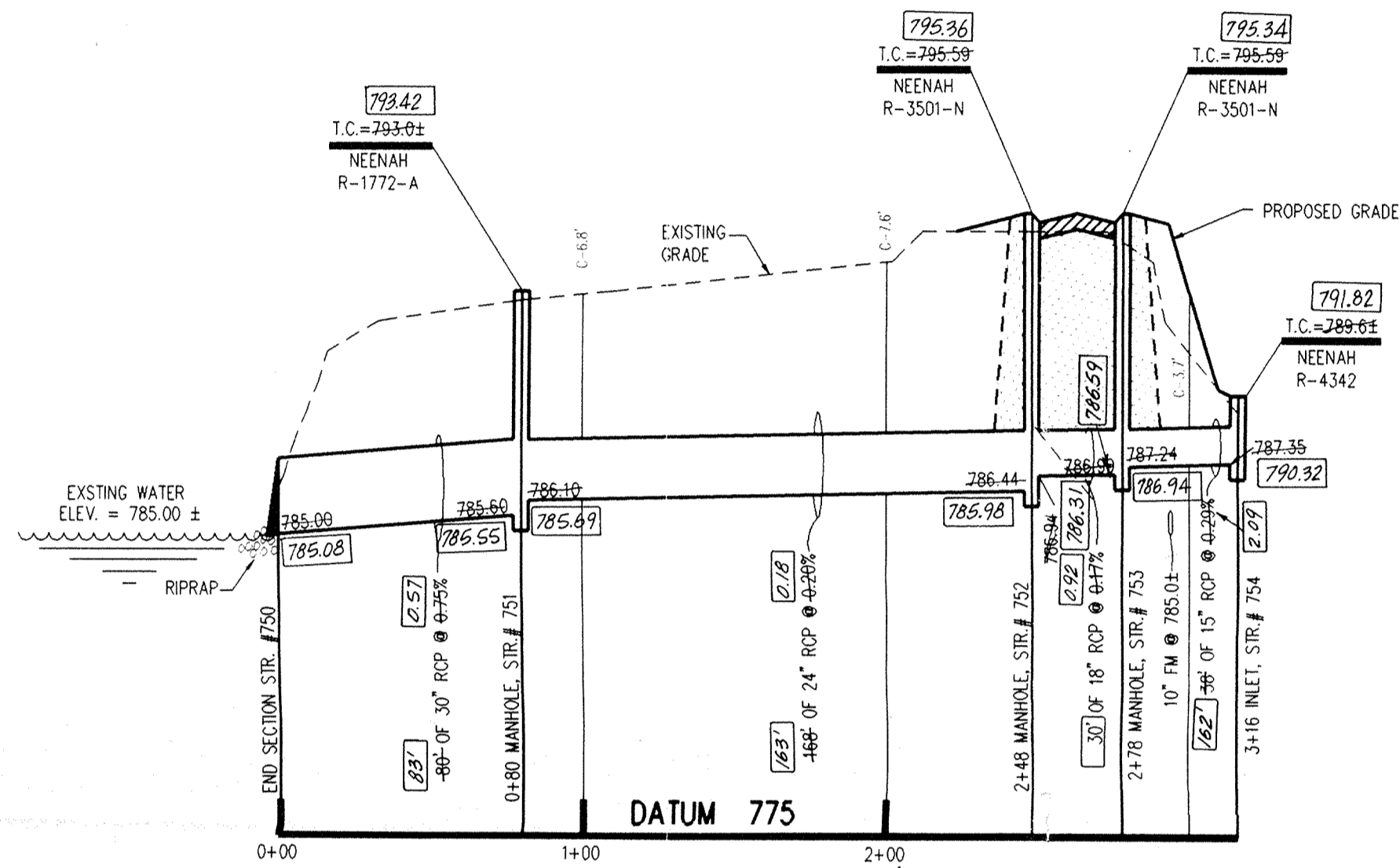

PROFILE ONE

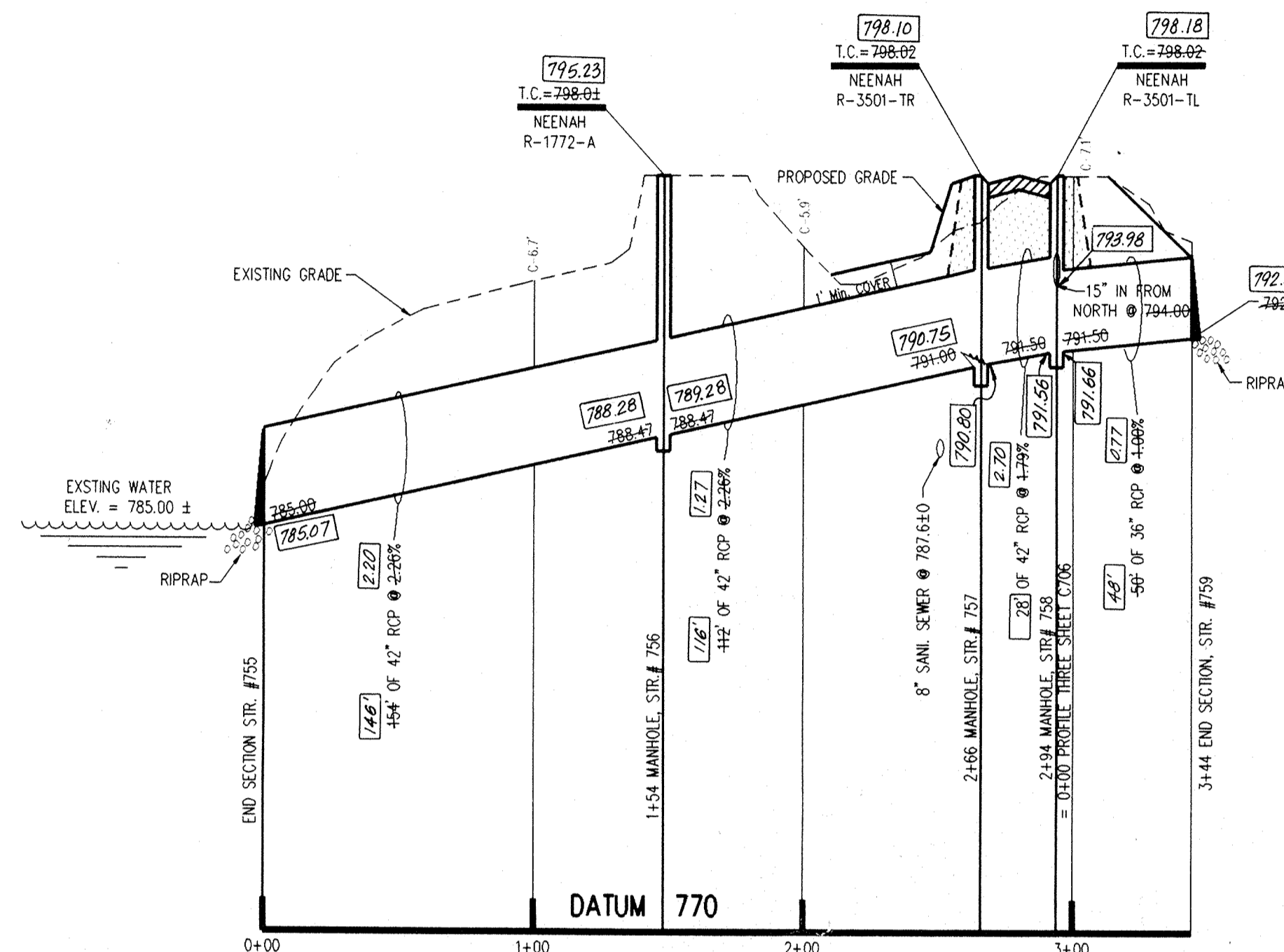

PROFILE TWO

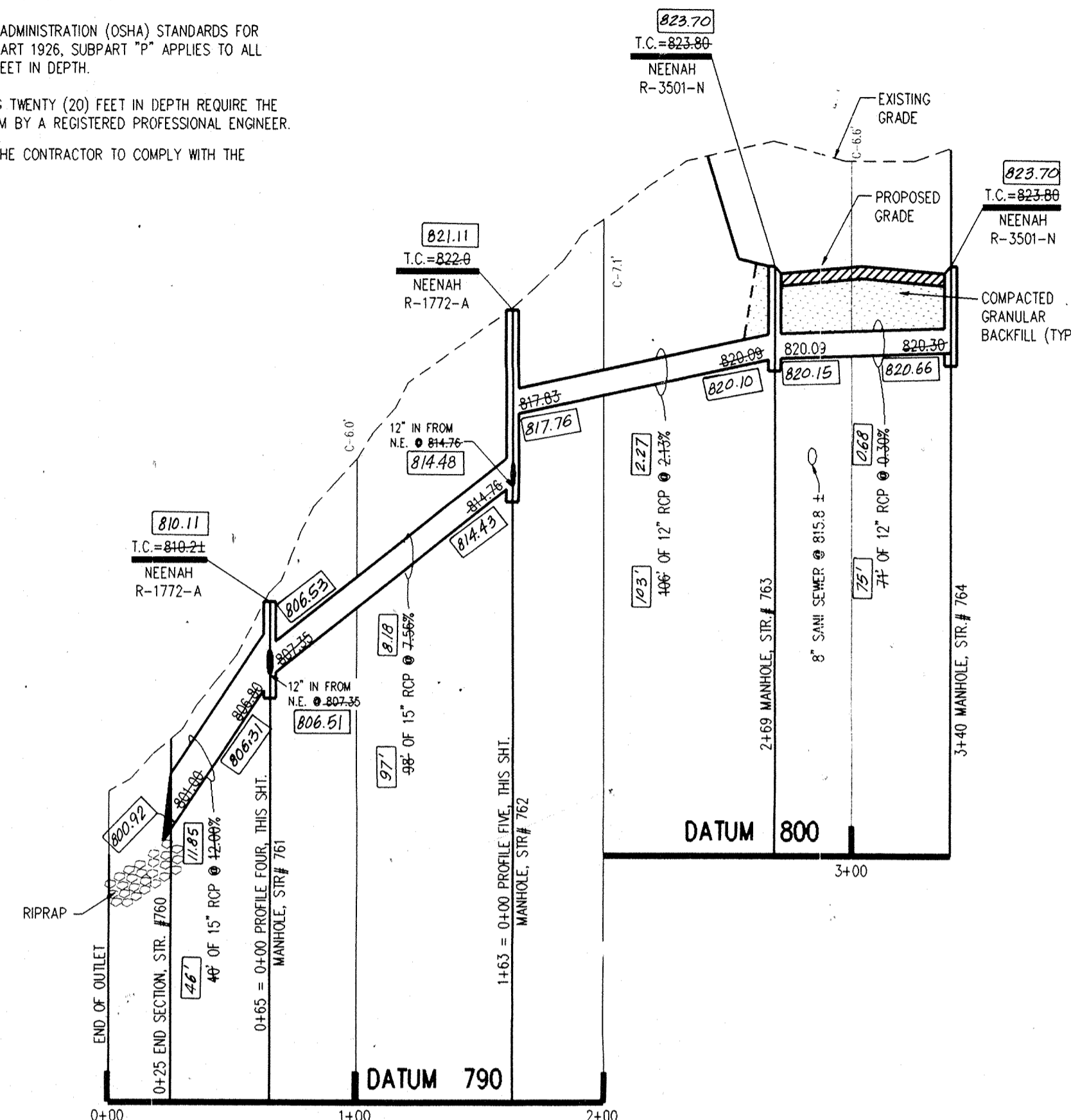

PROFILE THREE

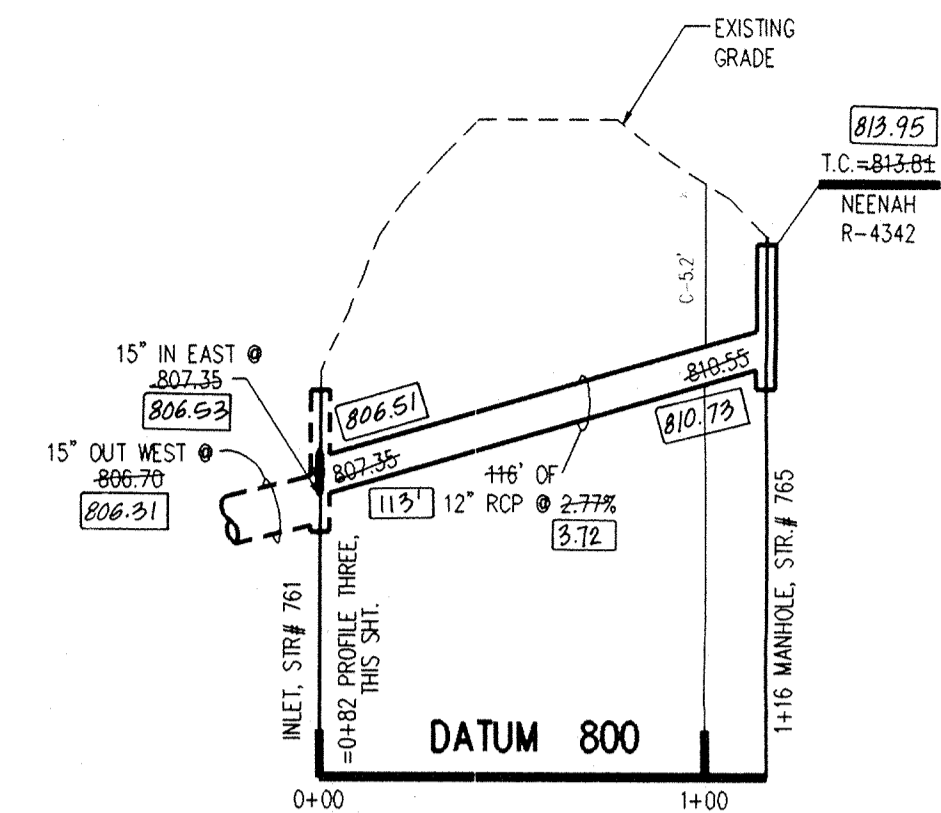

PROFILE FOUR

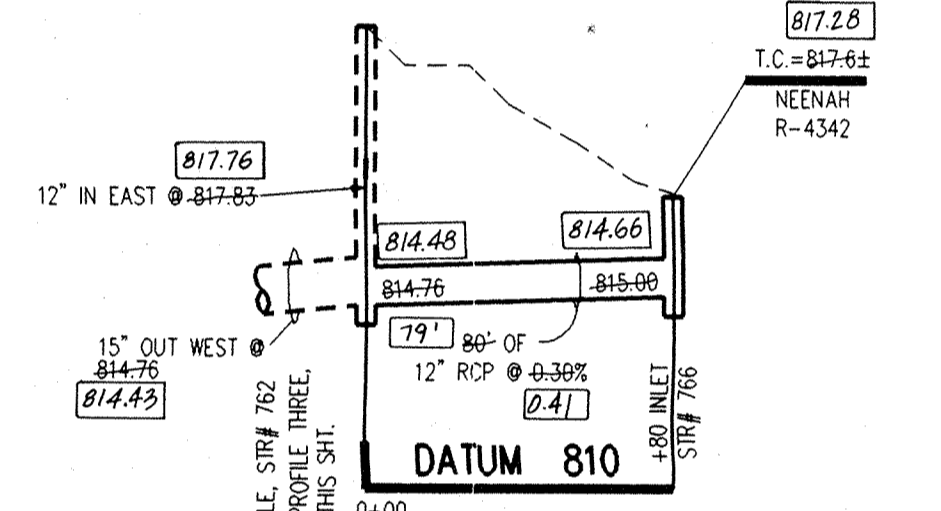

PROFILE FIVE

This information was gathered for input into the Hamilton County Geographical Information System. This document is considered an official record of the GIS.

Entry Date: 7-1-04

Entered by: JOH

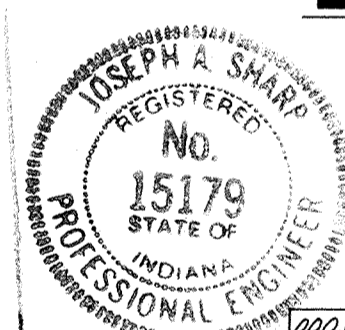

RECORD DRAWING

Certified by Joseph A. Sharp
12/22/99

0000 DENOTES AS BUILT INFORMATION

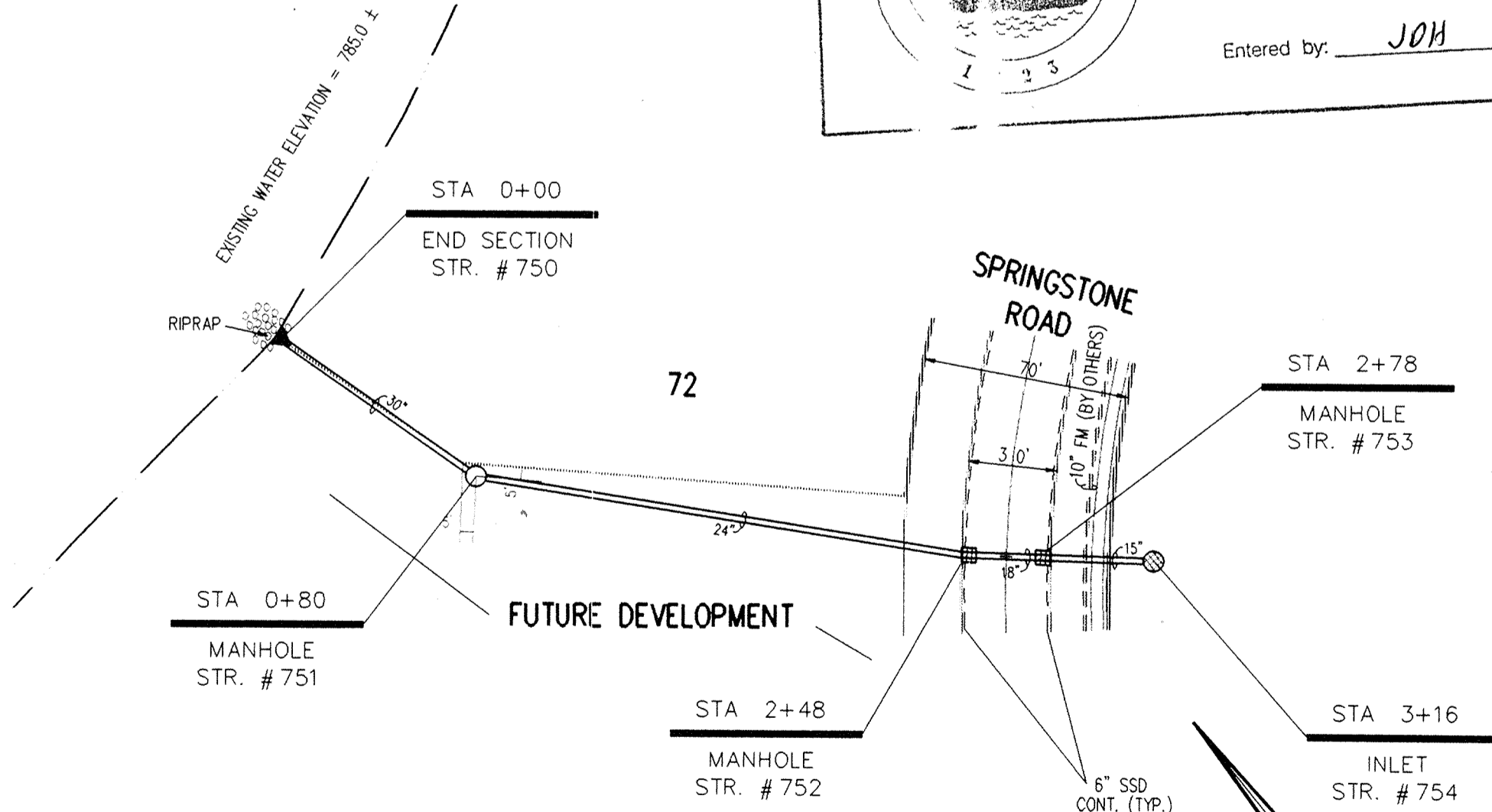

PLAN ONE

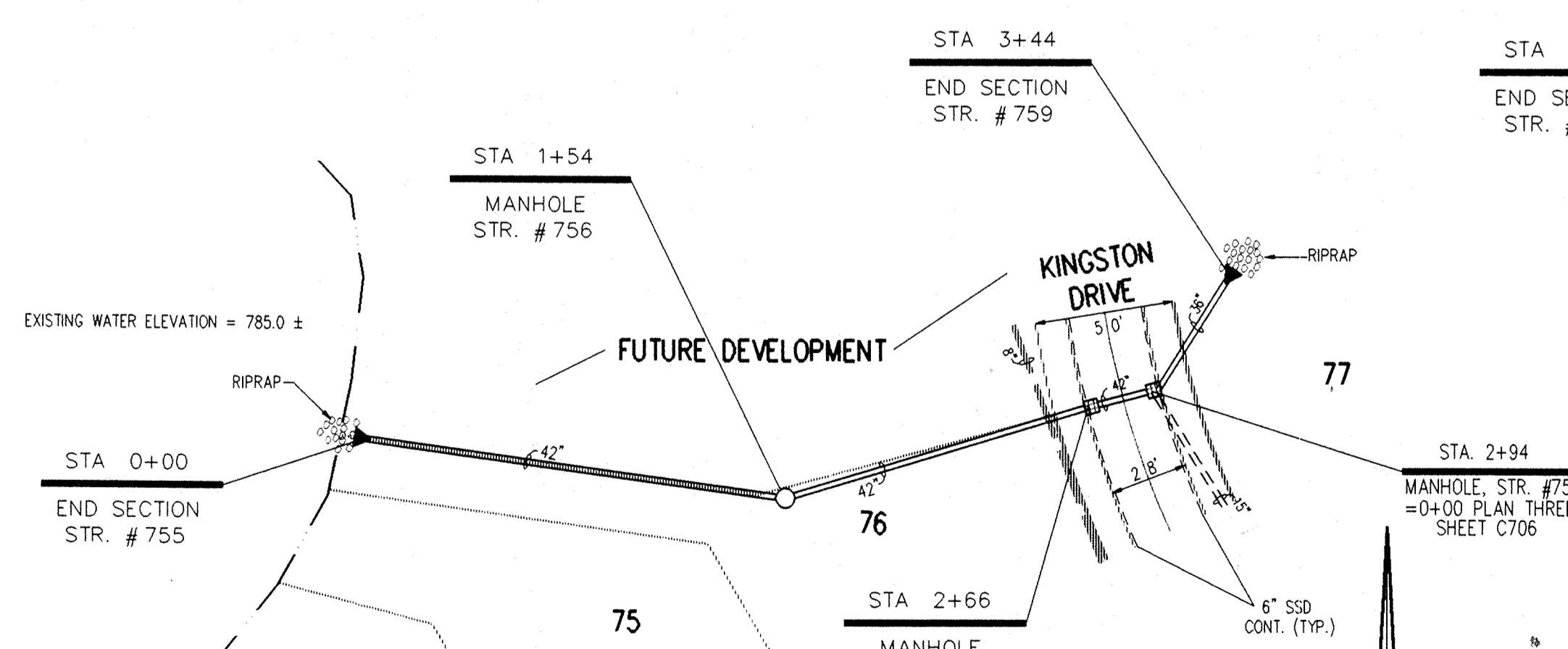

PLAN TWO

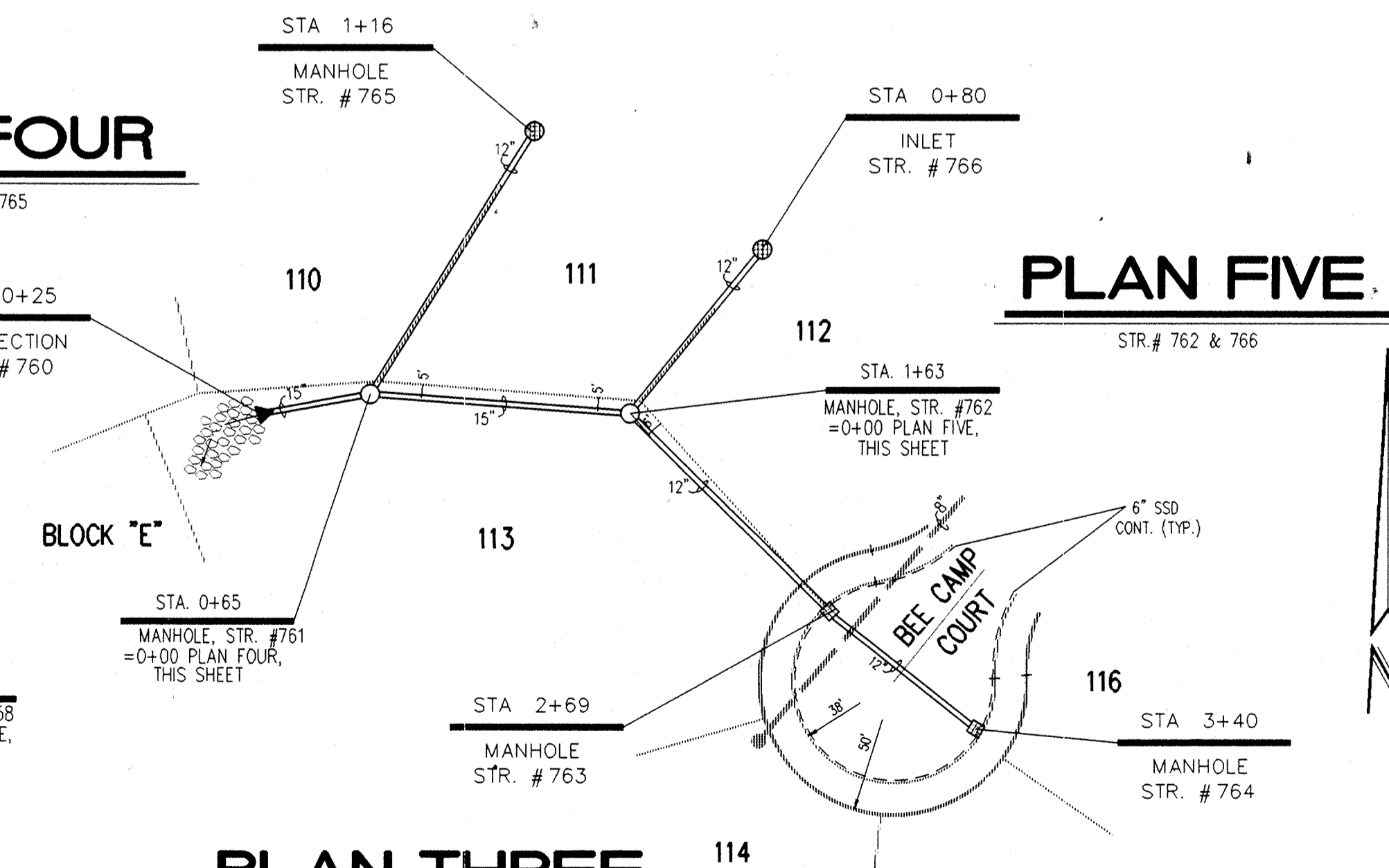

PLAN THREE

PLAN FOUR

PLAN FIVE



CERTIFIED BY:
Joseph A. Sharp
8.9.94 DATE

REVISIONS		
09/27/93 REVISED PER STREET GRADE REVISIONS	5-9-94 REVISED TO FOR STR. #751	B.1
2-8-94 REVISED PER DRAFTING CHECK	7-21-94 CHANGED INLET TO MANHOLE IF OVER 3' DEEP	B.1
3-15-94 REVISED LOT NUMBERS	12-22-94 AS BUILT STORM SEWERS	B.7
4-11-94 REVISED PLAN TWO		B.1

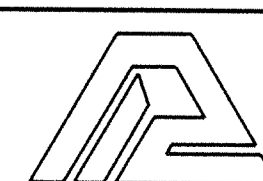

PAUL I. CRIFE, INC.
7172 GRAHAM ROAD
INDIANAPOLIS, INDIANA 46250
(317) 842-6277

- CIVIL ENGINEERING
- LAND SURVEYING
- ARCHITECTURE
- LAND PLANNING

CONCEPT CHK: _____
DRAWN BY: S.L.S.
ENG. CHK: _____
DRFTNG. CHK: _____

SCALE: HORZ. 50 VERT. 1"=5'
DRAWING TITLE: STORM SEWER PLAN & PROFILE

DATE: 8-28-93

CLIENT: MARINA LIMITED PARTNERSHIP

DWG. TYPE	FILE NUMBER	SHEET:
		C701
JOB NUMBER		
81100-22000		

THE SPRINGS OF CAMBRIDGE THREE & FOUR

FILED
NOV 15 1993
OFFICE OF HAMILTON COUNTY SURVEYOR

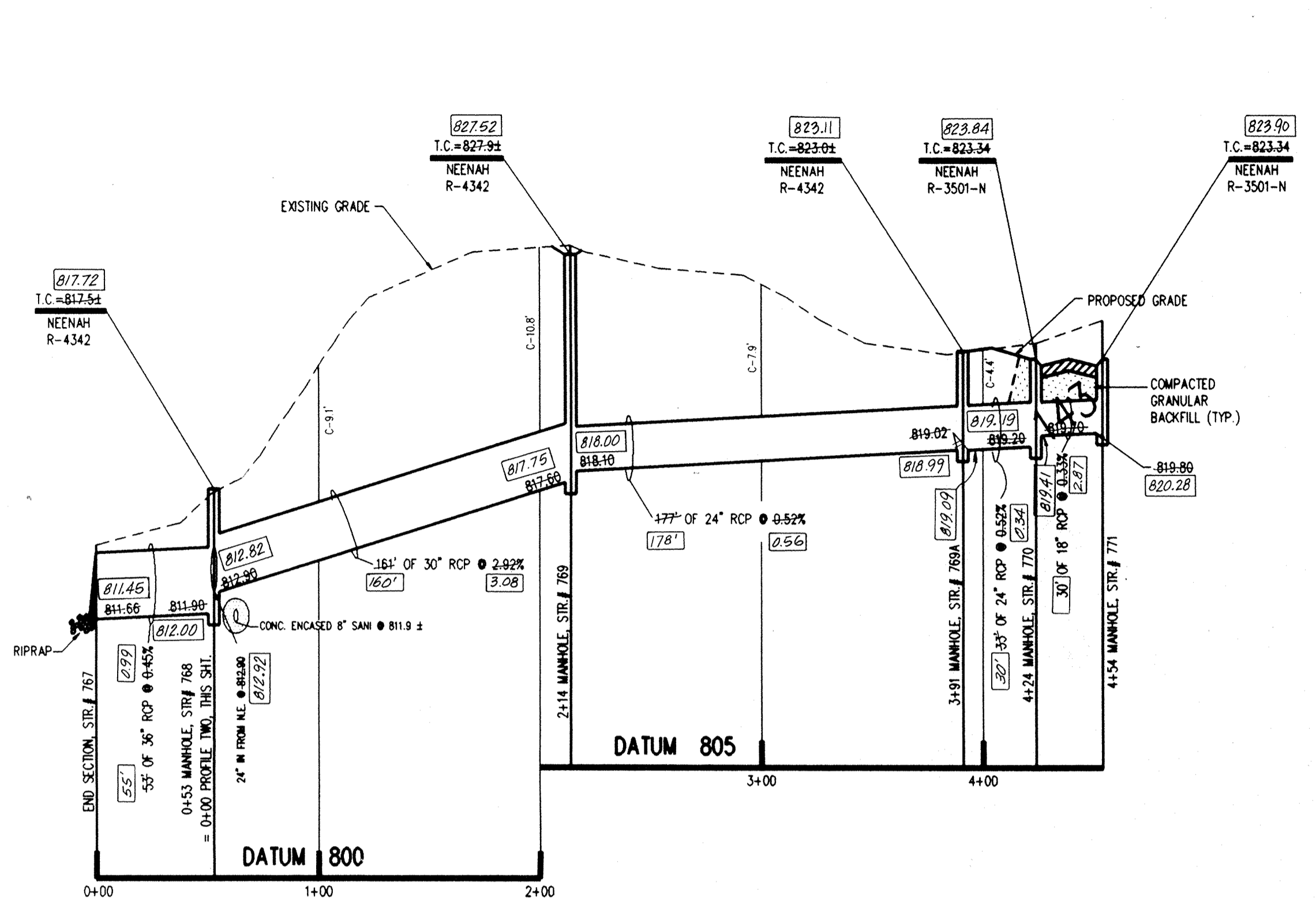

PROFILE ONE

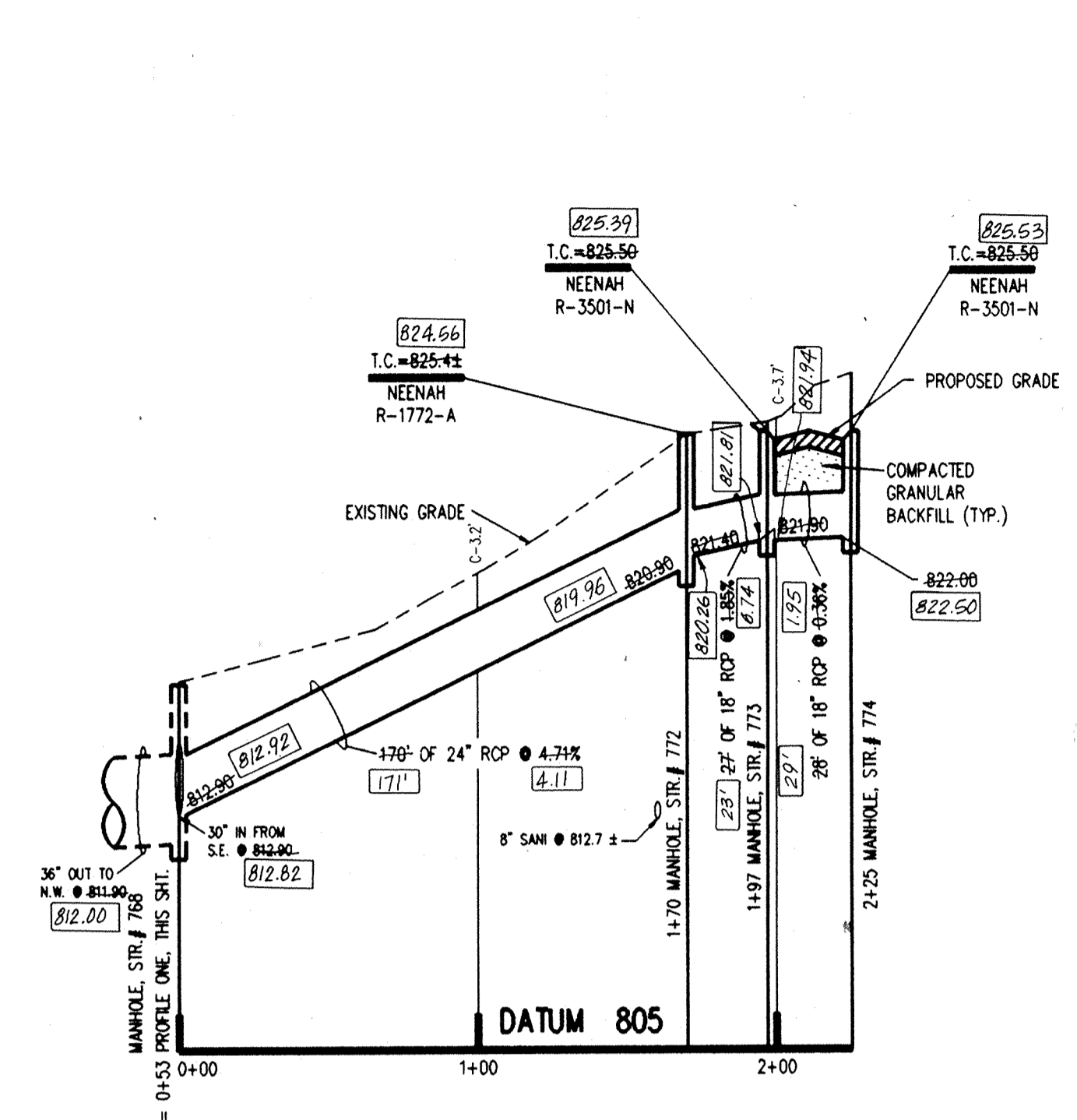

PROFILE TWO

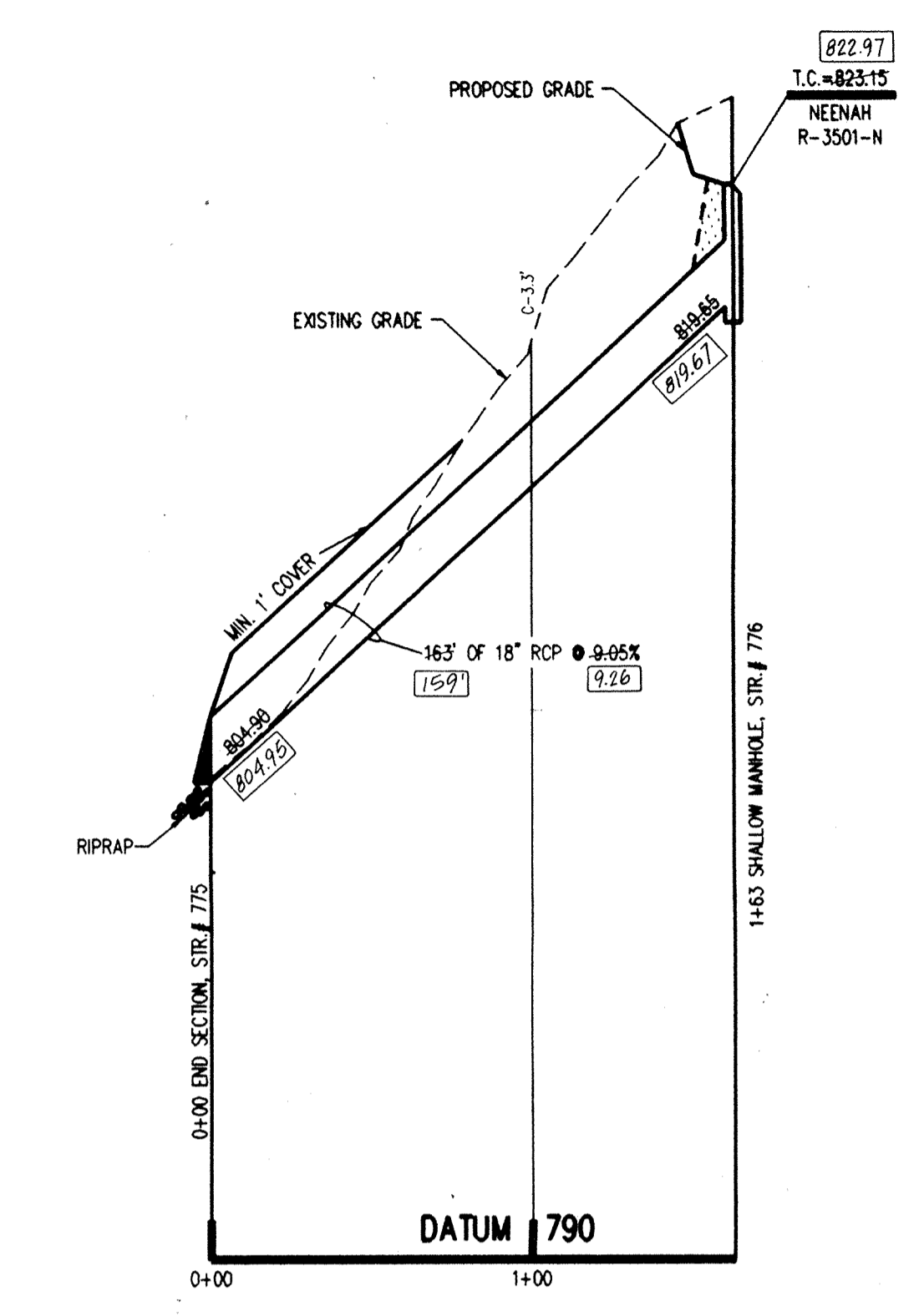

PROFILE THREE

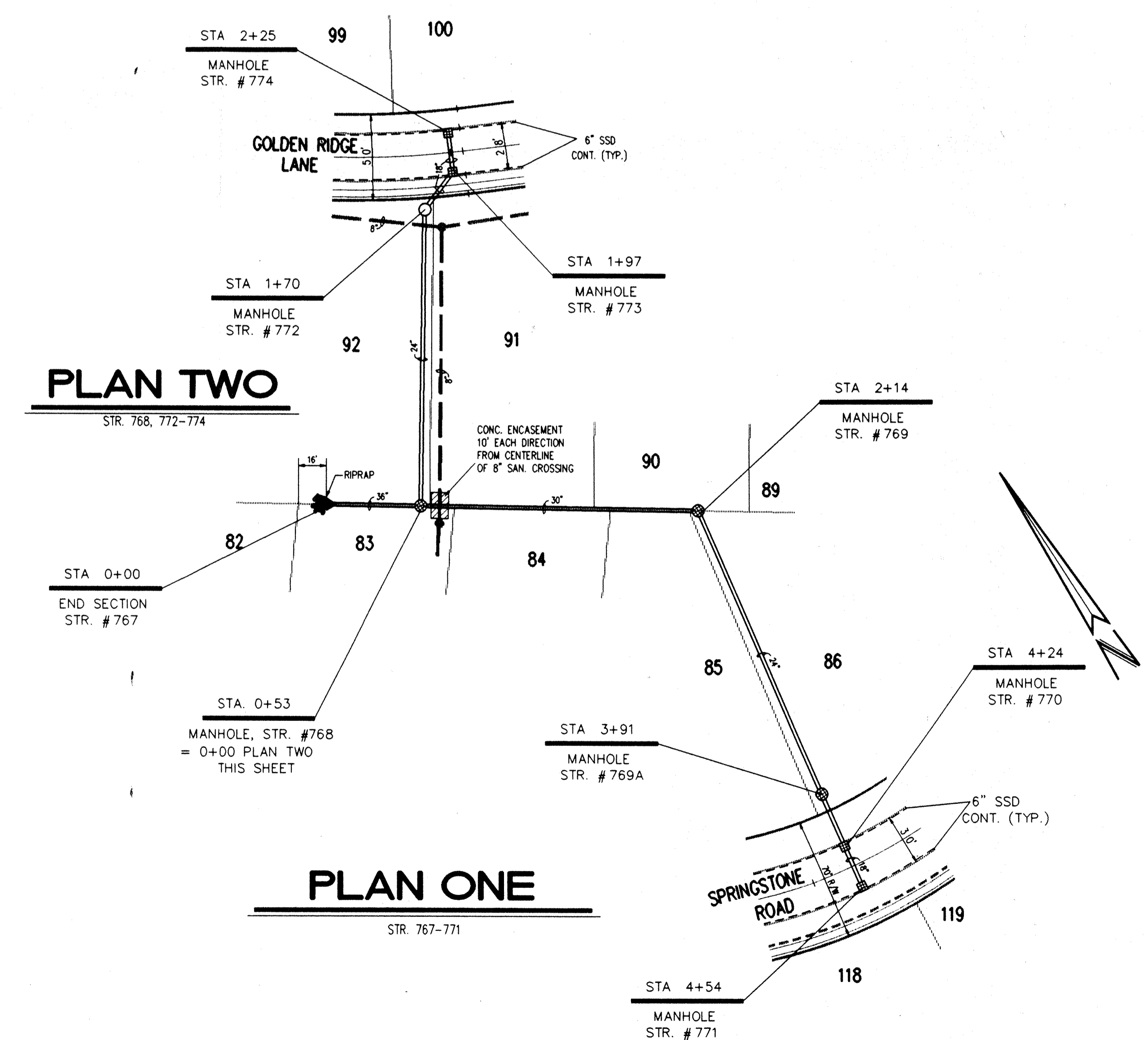

- NOTES:
1. CUTS SHOWN ARE APPROXIMATE, TAKEN FROM EXISTING GRADE TO INVERT OF PIPE.
 2. FIELD ADJUSTMENT BY ENGINEER MAY BE REQUIRED AT ALL OUTFALL POINTS TO INSURE PROPER OUTFALL CONDITIONS.
 3. ALL STORM DRAINAGE STRUCTURES (IE: MANHOLES, CURB INLETS) SHALL HAVE POURED FLOW LINES AND BENCH WALLS. THE FLOW LINES AND BENCH WALLS SHALL BE TROWELED SMOOTH AND HAVE A BRUSHED FINISH.
 4. ALL STRUCTURES SHALL HAVE CASTINGS, JOINTS, LIFT RINGS AND PIPE CONNECTIONS WELL GROUTED, TROWELED SMOOTH AND BRUSH FINISHED.
 5. OCCUPATIONAL SAFETY AND HEALTH ADMINISTRATION (OSHA) STANDARDS FOR EXCAVATIONS: FINAL RULE 29 CFR PART 1926, SUBPART PP APPLIES TO ALL EXCAVATIONS EXCEEDING FIVE (5) FEET IN DEPTH.
 6. IN ADDITION, EXCAVATIONS EXCEEDING TWENTY (20) FEET IN DEPTH REQUIRE THE DESIGN OF A TRENCH SAFETY SYSTEM BY A REGISTERED PROFESSIONAL ENGINEER.
- IT SHALL BE THE RESPONSIBILITY OF THE CONTRACTOR TO COMPLY WITH THE ABOVE STATED REQUIREMENTS.

This information was gathered for input into the Hamilton County Geographical Information System. This document is considered an official record of the GIS.

Entry Date: 7-1-04

Entered by: JOH

DON'T DIG BLIND

"HOLEY MOLEY" SEZ

CAUTION

LOCATIONS OF ALL EXISTING UNDERGROUND UTILITIES SHOWN ON THIS PLAN ARE BASED UPON ABOVE GROUND EVIDENCE (including, but not limited to, manholes, inlets, valves, and marks made upon the ground by others) AND ARE SPECULATIVE IN NATURE. THERE MAY ALSO BE OTHER EXISTING UNDERGROUND UTILITIES FOR WHICH THERE IS NO ABOVE GROUND EVIDENCE OR FOR WHICH NO ABOVE GROUND EVIDENCE WAS OBSERVED. THE EXACT LOCATIONS OF SAID EXISTING UNDERGROUND UTILITIES SHOULD BE VERIFIED BY THE CONTRACTOR PRIOR TO ANY AND ALL CONSTRUCTION.

1-800-382-5544
CALL TOLL FREE
1-800-428-5200
FOR CALLS OUTSIDE OF INDIANA

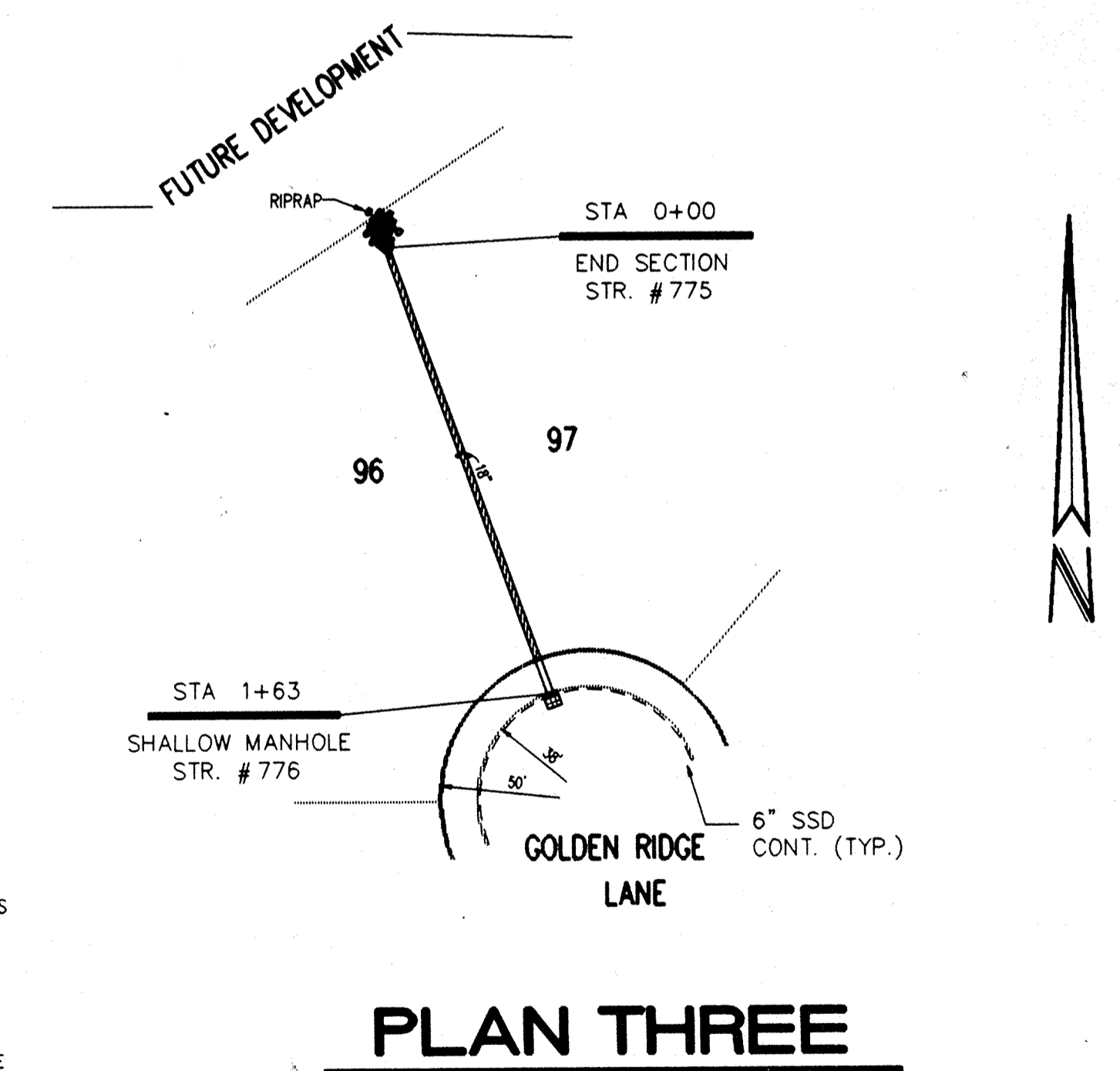

PLAN THREE

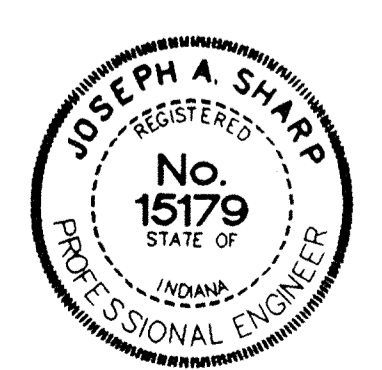

CERTIFIED BY:
Joseph A. Sharp
3-28-94 DATE

REVISIONS	B.T.
09/27/93 REVISED PER STREET GRADE REVISIONS	
2-8-94 REVISED PER DRAFTING CHECK	
3-15-94 REVISED LOT NUMBERS	
12-22-94 AS BUILT STORM SEWERS	

PAUL I. CRIFE, INC.

7172 GRAHAM ROAD
INDIANAPOLIS, INDIANA 46250
(317) 842-6777

- CIVIL ENGINEERING
- LAND SURVEYING
- ARCHITECTURE
- LAND PLANNING

CONCEPT CHK:	DRAWN BY: S.L.S.	SCALE: HORZ: 50 VERT: 1"=5'	DATE: 08/28/93	CLIENT: MARINA LIMITED PARTNERSHIP
ENG. CHK:	DRAFTING CHK:	DRAWING TITLE: STORM SEWER PLAN & PROFILE		

DWG. TYPE	FILE NUMBER	SHEET:
		C702
JOB NUMBER		
81100-22000		

RECORD DRAWING

Certified by *Joseph A. Sharp* LED
12/22/94

NOV 15 1995
OFFICE OF HAMILTON COUNTY SURVEYOR

THE SPRINGS OF CAMBRIDGE SECTIONS THREE & FOUR

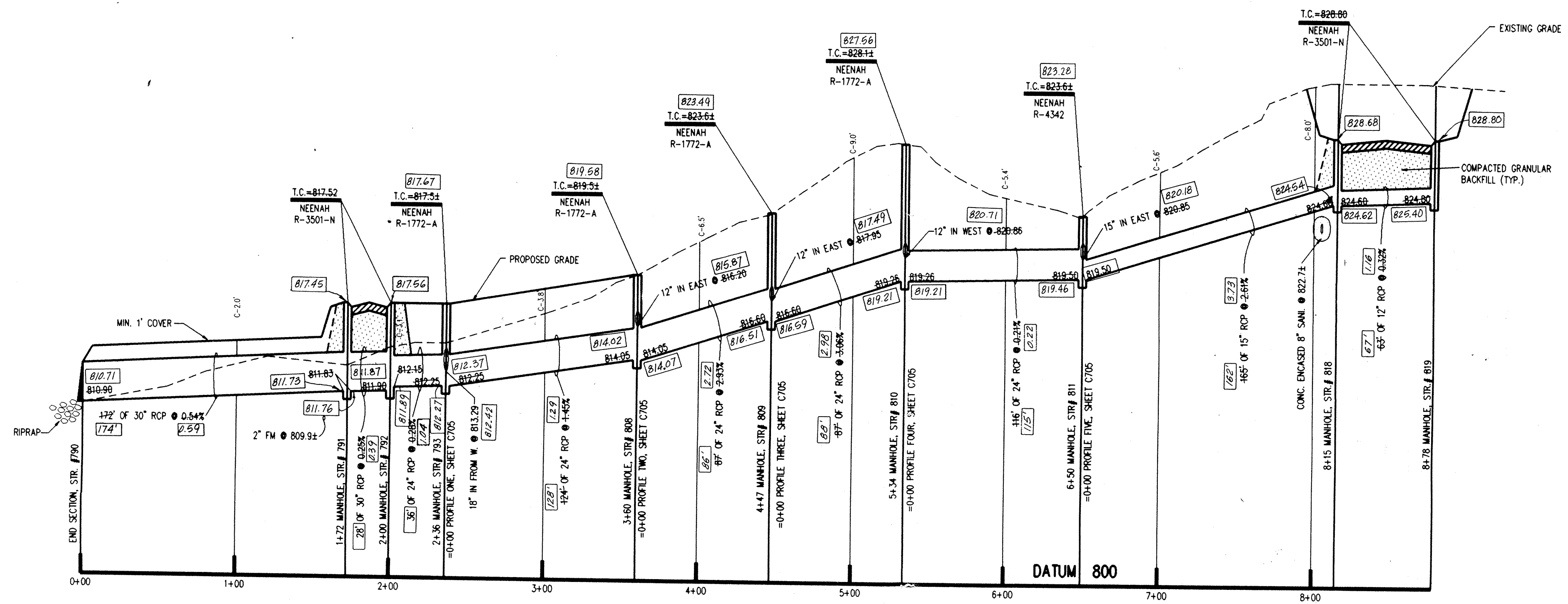

PROFILE ONE

- NOTES:
- CUTS SHOWN ARE APPROXIMATE, TAKEN FROM EXISTING GRADE TO INVERT OF PIPE.
 - FIELD ADJUSTMENT BY ENGINEER MAY BE REQUIRED AT ALL OUTFALL POINTS TO INSURE PROPER OUTFALL CONDITIONS.
 - ALL STORM DRAINAGE STRUCTURES (I.E. MANHOLES, CURB INLETS) SHALL HAVE POURED FLOW LINES AND BENCH WALLS. THE FLOW LINES AND BENCH WALLS SHALL BE TROWELED SMOOTH AND HAVE A BRUSHED FINISH.
 - ALL STRUCTURES SHALL HAVE CASTINGS, JOINTS, LIFT RINGS AND PIPE CONNECTIONS WELL GROUTED, TROWELED SMOOTH AND BRUSH FINISHED.
 - OCCUPATIONAL SAFETY AND HEALTH ADMINISTRATION (OSHA) STANDARDS FOR EXCAVATIONS; FINAL RULE 29 CFR PART 1926, SUBPART "P" APPLIES TO ALL EXCAVATIONS EXCEEDING FIVE (5) FEET IN DEPTH.
 - IN ADDITION, EXCAVATIONS EXCEEDING TWENTY (20) FEET IN DEPTH REQUIRE THE DESIGN OF A TRENCH SAFETY SYSTEM BY A REGISTERED PROFESSIONAL ENGINEER.
- IT SHALL BE THE RESPONSIBILITY OF THE CONTRACTOR TO COMPLY WITH THE ABOVE STATED REQUIREMENTS.

DON'T DIG BLIND

"HOLEY MOLEY" SET

1-800-382-5544
CALL TOLL FREE
1-800-428-5200
FOR CALLS OUTSIDE OF INDIANA

CAUTION

LOCATIONS OF ALL EXISTING UNDERGROUND UTILITIES SHOWN ON THIS PLAN ARE BASED UPON ABOVE GROUND EVIDENCE (INCLUDING, BUT NOT LIMITED TO, MANHOLES, INLETS, VALVES, AND MARKS MADE UPON THE GROUND BY OTHERS) AND ARE SPECULATIVE IN NATURE. THERE MAY ALSO BE OTHER EXISTING UNDERGROUND UTILITIES FOR WHICH THERE IS NO ABOVE GROUND EVIDENCE OR FOR WHICH NO ABOVE GROUND EVIDENCE WAS OBSERVED. THE EXACT LOCATIONS OF SAID EXISTING UNDERGROUND UTILITIES SHOULD BE VERIFIED BY THE CONTRACTOR PRIOR TO ANY AND ALL CONSTRUCTION.

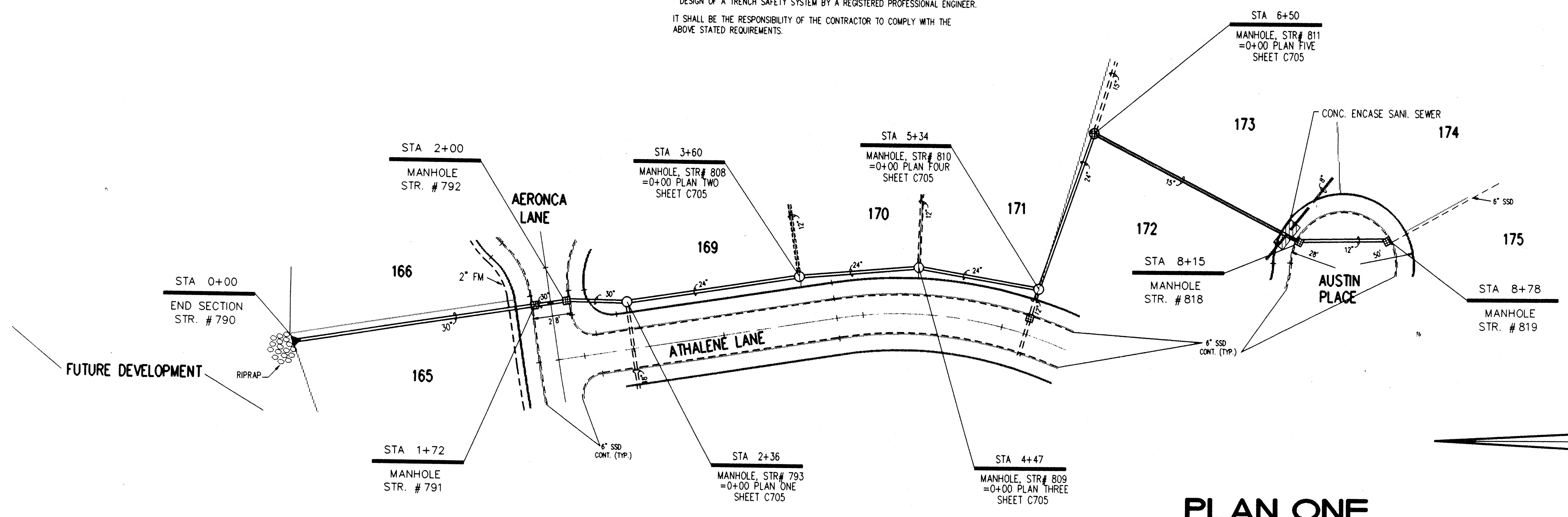

PLAN ONE

HAMILTON COUNTY INDIANA

This information was gathered for input into the Hamilton County Geographical Information System. It is not to be considered an official record of the GIS.

Entry Date: 7-1-04
Entered by: JOH

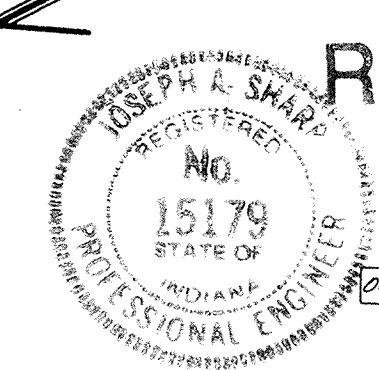
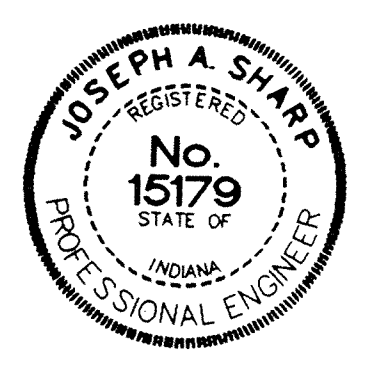

RECORD DRAWING

Certified By Joseph A. Sharp
12/22/94
FILED

NOV 15 1995
OFFICE OF HAMILTON COUNTY SURVEYOR

CERTIFIED BY: <i>Joseph A. Sharp</i> 1-3-28-94 DATE	REVISIONS		PAUL I. CRIFE, INC. 7172 GRAHAM ROAD INDIANAPOLIS, INDIANA 46250 (317) 842-6777	CIVIL ENGINEERING LAND SURVEYING ARCHITECTURE LAND PLANNING	CONCEPT CHK:	DRAWN BY: S.L.S.	SCALE: HORZ. 1"=50' VERT. 1"=5'	DATE: 08/28/93	CLIENT: MARINA LIMITED PARTNERSHIP	DWG. TYPE	FILE NUMBER	SHEET: C704
	9-27-93 REVISED PER STREET GRADE REVISIONS 2-8-94 REVISED PER DRAFTING CHECK 3-15-94 REVISED LOT NUMBERS 12-22-94 AS BUILT STORM SEWERS	B.T. B.T. B.T.			ENG. CHK: DRFTNG. CHK:	DRAWING TITLE: STORM SEWER PLAN & PROFILE	JOB NUMBER 81100-22000					

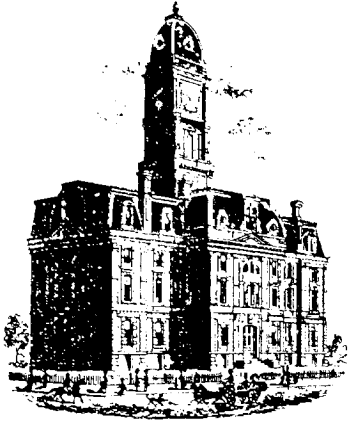

SURVEYOR'S OFFICE
Hamilton County

Kenton C. Ward, CFM
Surveyor of Hamilton County

Phone (317) 776-8495

Fax (317) 776-9628

Suite 188

One Hamilton County Square
Noblesville, Indiana 46060-2230

Map Correction-Field Verification

Drain Number: 262

Drain Length: n/a

Drain Name: Springs of Cambridge Sec. 3

Change +/- : 0

Date: 05-21-2009

New Length: n/a

Verified By: SLM & SAB

Notes & Sketch: See attached Map

The open ditch across lots 78 to 83 in Springs of Cambridge Section 3 was enclosed with 10 feet of 12" RCP. An end section was also added. This is Structure 100 on the attached map. This was done with Work Order: WO-2009-0013.

Suzanne L. Mills
GIS Specialist

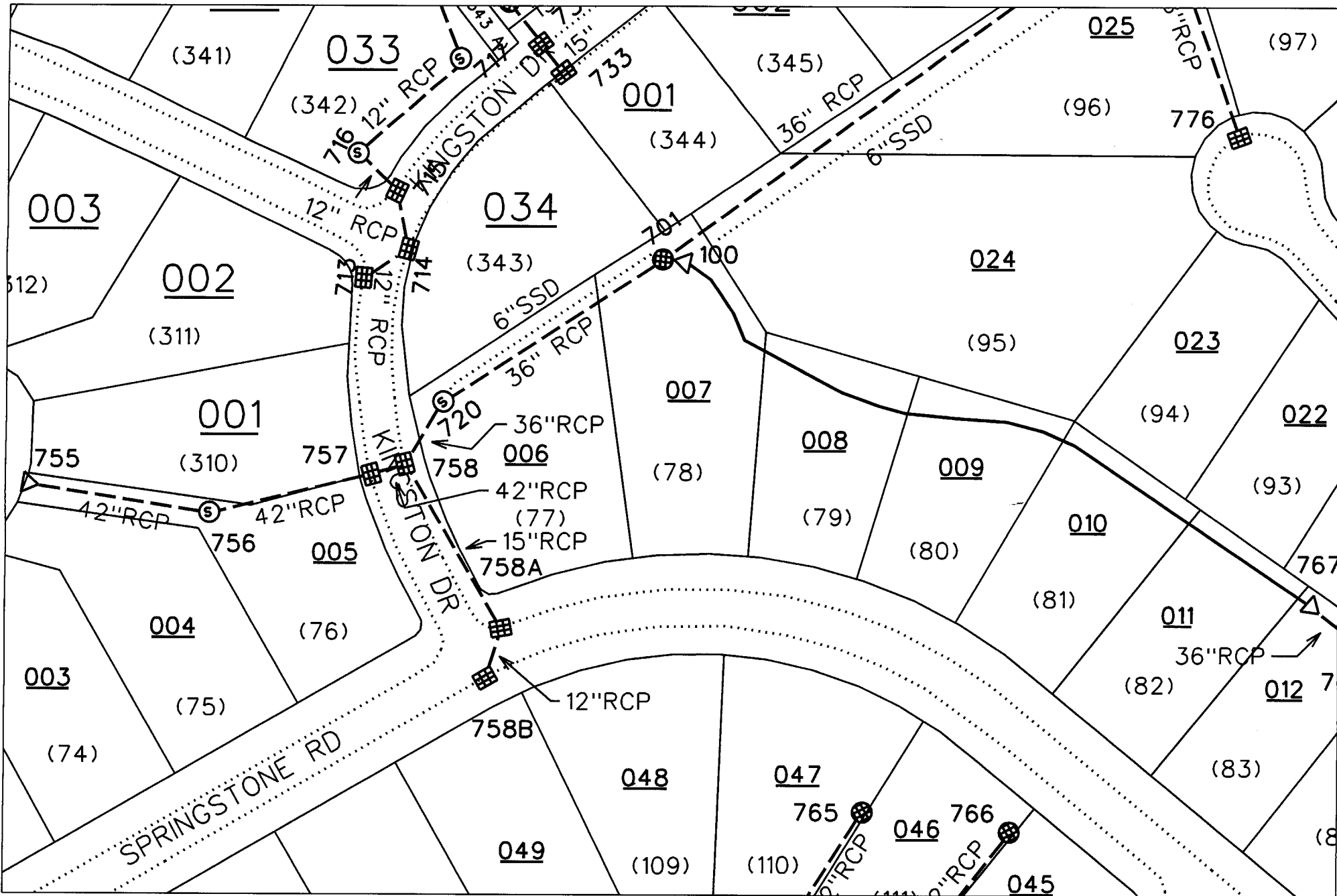

sub_rg_drn.dgn 5/22/2009 10:08:40 AM